

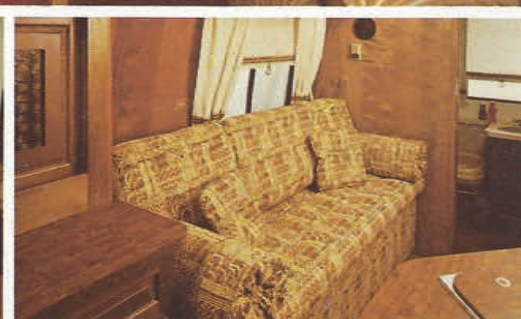

# Birchaven





## the GMC Birchaven Motor Home

Treat yourself to the ultimate in travel elegance and superb craftsmanship. With luxury appointments like rich birch

cabinetry and paneling, padded carpets and soft look upholstery. The kitchen comes complete with double stainless

steel sink, 3-way refrigerator, 4-burner range and optional microwave oven and food blender. The Birchaven features a roomy bath, a dinette that converts to a double bed and a gaucha that

makes into a full bed and bunk. You'll enjoy a quiet, smooth and responsive ride. The Birchaven motor home—a unique blend of luxury, performance and innovation.



## Standard Equipment

Dual holding tanks  
40 gallon water tank  
62 lb. LP gas tank  
30,000 BTU forced air furnace  
w/ electronic ignition & thermostat  
6 gallon LP water heater w/ engine  
preheat & electronic ignition  
30 AMP power cord  
Ground fault interrupter  
110 Volt exterior duplex receptacle  
12 Volt lighting

12 Volt Triad power converter w/ fuse  
panel and battery charger  
Rear mounted container for disposal  
hose  
Systems monitoring panel  
City water hookup  
Potable gravity water fill  
Fire extinguisher  
12 Volt water pump  
Foam insulation  
AM/ FM stereo radio w/ 8 track

## Standard Features

Rich birch interior  
Carpeting with foam padding  
Soft-look "Herculon" upholstery  
Decorator pillows  
Head and arm covers on pilot seats  
Divider drapes (driver/living area)  
Decorative window shades with side  
drapes  
Folding wood parquet door  
Front dinette w/ table featuring recessed  
coasters. Dinette converts to a  
double bed.  
Rear, side-facing settee with recessed  
extension table on 23' SB converts  
to a double bed.  
Double stainless steel sink w/ faucet  
& spray  
Combination sink covers/ serving trays  
6 Cubic ft. 3-way refrigerator  
4-burner range w/ smoked glass oven  
door, stainless steel range top and  
power range vent w/ light

Laminated countertops  
Complete bath-marine-type stool, tub  
w/ personal shower, medicine cabinet  
and exhaust fan (RB only)  
Molded bath module w/ full width vanity,  
medicine cabinet w/ sliding doors,  
personal shower and exhaust fan  
(SB only)  
Cedar lined wardrobe w/ light and  
carpeted shelf  
Interior courtesy light  
Porch light  
Outside accent stripes  
Hutch/refreshment center combo  
(23RB only)  
Hamper (23 SB)  
Interior decors: Gunpowder, Spring,  
Wheat & Rust

## Chassis Specifications

403-Cubic inch V-8 engine with 3-speed  
automatic transmission  
Front wheel drive  
Hydraulic front and rear bumpers  
6-wheel power brakes  
Power steering  
Independent air-suspended tandem rear  
wheels with automatic height control.  
Dual 25 gallon fuel tanks  
Deluxe tilt wheel  
Cruise control

## FLOOR PLANS

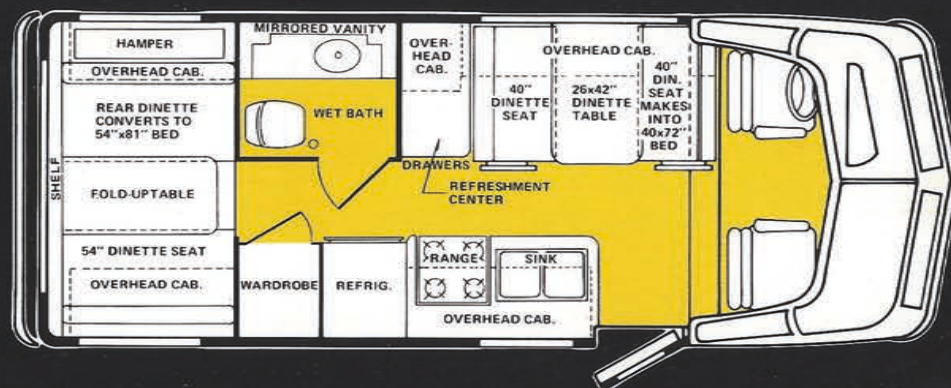

**Birchaven Side Bath**

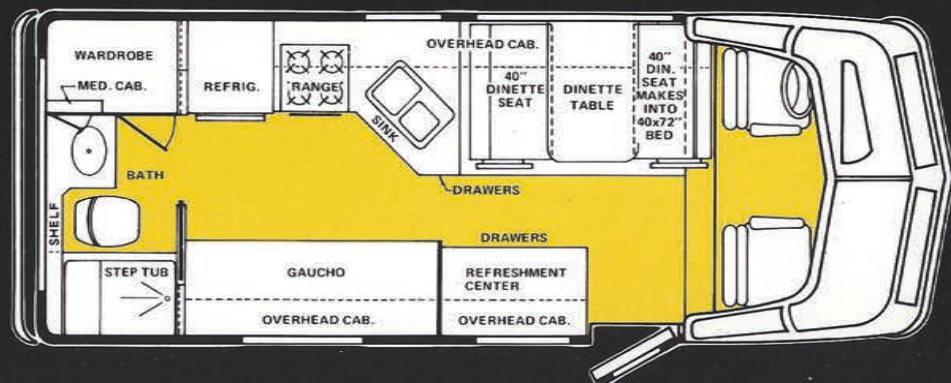

**Birchaven Rear Bath**

## Options:

Snack tray  
Auxiliary battery pack  
4,000 Watt Onan generator  
Gas & electric lines for generator  
TV antenna  
Roof rack and ladder  
11,000 or 13,500 BTU air conditioner  
Single swing-up bunks (RB only)  
Pull down bunk w/ ladder (SB only)  
Sofa option (replaces dinette seats)  
Microwave oven (SB only)  
Food blender  
Digital clock  
Water purifier  
Vacuum cleaner



# Jimmy EXTRAS

**THE R.V.I.A. SEAL** The Recreational Vehicle Industry Association (R.V.I.A.) is the national trade association serving the recreational vehicle industry. Manufacturers must comply with federal construction standards to belong to R.V.I.A. Before you invest in a recreational vehicle, look for the R.V.I.A. seal. It's your assurance of a safe, dependable travel home.



**ONE STOP SERVICE** Your authorized Jimmy dealer offers you the finest of service people and facilities. He can provide you with service on your GMC chassis as well as the Jimmy body. This means you'll get fast one stop service. Your Jimmy card makes you a part of an exclusive club of Jimmy owners.



**OWNERS MANUAL** The unit's gas, electrical and plumbing systems; its running gear; winter storage; and use; and maintenance are among the subjects included in the Owners Manual.



**COACH LITE SUPPLY** For dependable replacement parts, accessory items and general supplies, see your Coach-Lite Dealer. Coach-Lite Supply Company is the largest Warehouse Distributor in the United States, having five major warehouses across the country. You benefit from Coach-Lite's volume buying of new and better products when you shop at a Coach-Lite Dealer store. Ask your local Dealer for a new comprehensive Coach-Lite Campware catalog.



**FAHERTY GMC**  
THE TRUCK PEOPLE FROM GENERAL MOTORS

P.O. Box 969 Hwy. 53 North  
Eau Claire, Wisconsin 54701  
Phone 715-835-2204

# THE Jimmy LINE

The **GMC Motor Homes** are sleek outside, luxurious and fully equipped inside. Design and decor are harmonized to please the most discriminating eye and the most demanding traveler. The masterfully planned GMC Motor Home, for your travel pleasure.



The **Jimmy Mini**. Uncompromised quality in a mini motor home. Skilfully engineered and designed. Interiors are bright and attractive, yet durable enough for family wear and tear. Complete kitchen, bath, dining and sleeping facilities. Everything you need for self-contained travel freedom.



The **Jimmy Van** offers year 'round travel fun—economically. Its unique convenience features make traveling a snap. A perfect vehicle for carpools or for camping. The Jimmy Van gives you motor home roominess with the driving ease and economy of a passenger car.



The **Jimmy Travel Van** is the ultimate versatile van. Smooth riding, easy handling and economical. The Travel Van works hard and plays hard. From hauling the kids to entertaining guests. Enjoy The Jimmy Travel Van for luxurious travel or practical transportation.



Coachmen Industries works year 'round to improve its products. Accordingly all specifications, equipment, and prices set forth in Jimmy literature are subject to change without notice and/or obligations.

# Jimmy MOTOR HOMES

DIVISION OF COACHMEN INDUSTRIES, INC.

1100 N. Woodlawn Ave. Elkhart, Indiana 46514 Telephone 219-262-2645