



HUGHES/GMC

GMC 26'

By

Hughes Motor Coach

Announcing the all new 26 foot GMC by Hughes Motor Coach—it's here, the all new luxurious HUGHES/GMC coach.

After selling hundreds of motor homes—most to experienced users—we have accumulated a wealth of information about the features that constitute a good motor home. We have used this knowledge in developing the new HUGHES/GMC coach.

The standard coach includes 10 cubic foot gas electric fridge, 4000 watt generator, automotive air conditioning, cruise control, AM/FM Stereo radio with tape, roof air conditioning and much more. Some of the usefull options include rear automotive heater, microwave oven, roof rack and ladder, roof top storage pod, sun roof, drivers overhead control console, we can even offer interior and exterior colour schemes to suit the customers individual taste.

Nobody should buy a medium or luxury priced motor home until they have seen and driven the HUGHES/GMC coach available in mid or rear bathroom floor plans.

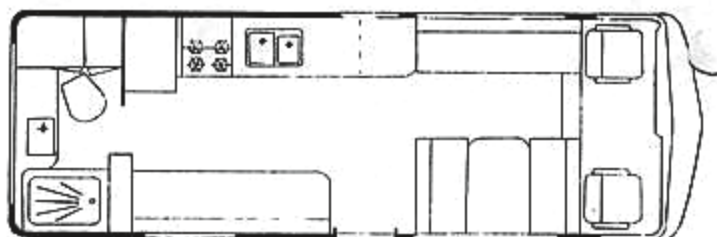
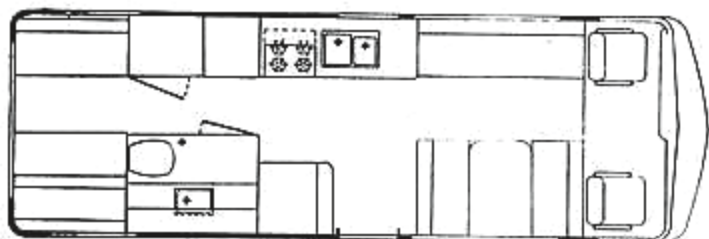

26'

STANDARD FEATURES AND EQUIPMENT

- 4,000 watt generator
- Automotive Air Conditioning
- Cruise Control
- AM/FM Stereo Radio With Tape
- Roof Air Conditioning
- Tilt Steering Wheel
- Adjustable Air Ride Suspension, Rear
- Torsion Bar Suspension Front
- Wheel Covers
- Built in Trouble Light on 25 foot Cord
- Spare Tire Carrier and Cover
- Fender Skirts
- Front Wheel Drive
- GMC Custom Chassis with 402 Engine
- Power Steering and Power Brakes
- Holding Tank Capacity
 - 35 Gals Mid Bath
 - 55 Gals Rear Bath
- Fresh Water System
 - 35 Gals Mid Bath
 - 50 Gals Rear Bath
- Sun Visors
- Tinted Safety Glass Windows
- Lighted Assist Handle and Courtesy Floor Lights
- Dual Batterys with Auto Charge and Emergency Start Circuit
- Electronic Control Panel Monitors, Water Level, Holding Tank Levels, Fridge Pilot Light, LP Gas, Battery Condition, Remote Generator Start and Hour Meter, Battery Operated Clock and Inside Thermometer
- 6 Gallon Gas Water Heater
- Deluxe Plush Carpeting Throughout
- Power Vents in Bathroom and Main Cabin

- Very High Quality Interior Upholstery
- Double Stainless Steel Sinks
- Rear Window Emergency Exit
- Conveniently Located Drain Hose and Sanitary Carrier
- 40 AMP Power Converter
- 10 Cubic Foot Gas Electric Fridge
- 4 Burner Range with Eye Level Oven
- 30,000 BTU Forced Air Furnace
- 200 AMP Auxiliary Battery
- Convertable Chesterfield to Upper and Lower Bunks
- Front Wrap Around Privacy Drapes
- Sink Covers
- Dual Safety Regulator on Propane System
- 62 lb. Propane Tank
- 46 Gallon Gasoline Tank with Reserve

OPTIONAL EQUIPMENT

- Roof Top Storage Pod Colour Matched To Exterior Paint Colour
- TV Antenna
- CB Radio
- Countertop Blender
- Central Vacuum System
- Roof Rack and Ladder
- Colour TV—PANASONIC
- Sun Roof
- Drivers Overhead Console
- Driver & Passenger Roof Windows
- Radial Tires and High Stress Rims
- Turbo Charger [available shortly]

NOTE: As a result of product improvement specifications and equipment and prices are subject to change without notice.

HUGHES MOTOR HOMES

R.R.2, ORANGEVILLE, ONTARIO L9W 2Y9 (519) 941-0759