

FUELING PROBLEMS

GMC 2017 SPRING CONVENTION
SHAWNEE, OKLAHOMA

PAUL DOANE

DISCLAIMER:

I am not an automotive engineer, I am not an engineer, I am not even close. The information I am giving you today is a result of my research on the subject and my experience working on my coach. I would urge you to verify all information and come to your own conclusions before making any changes to your coach.

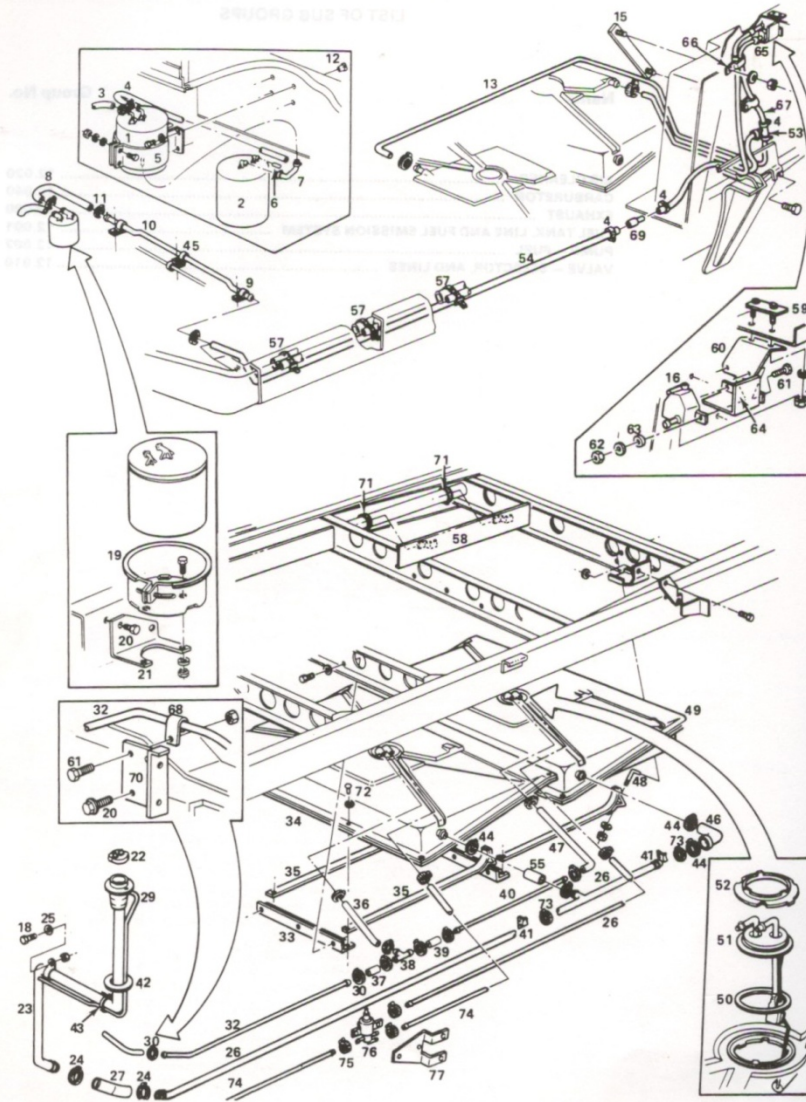

12P-6060-177

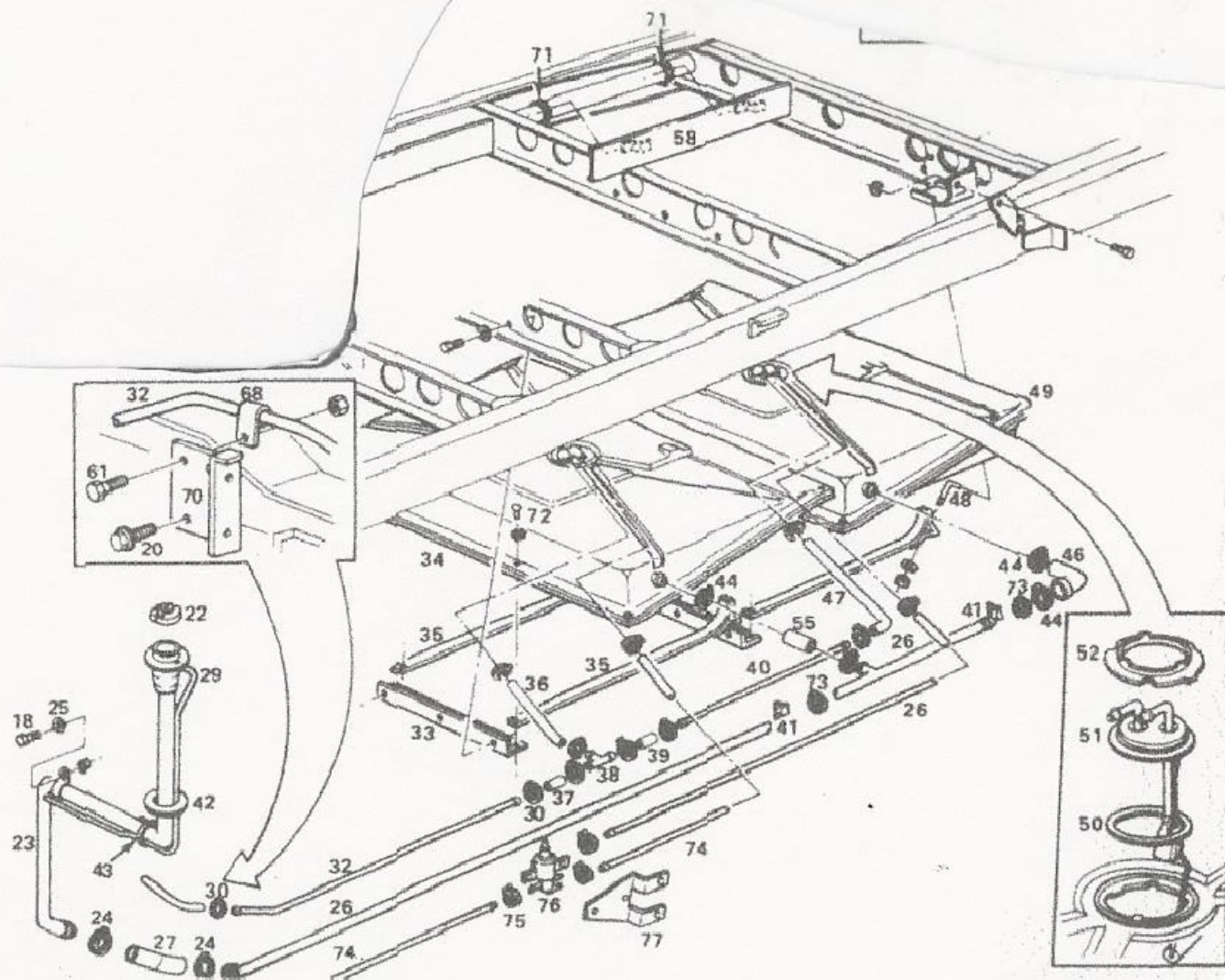

12P-6060-177

12.001 FUEL TANK, LINES & FUEL EMISSION SYSTEM

12-2

FUEL

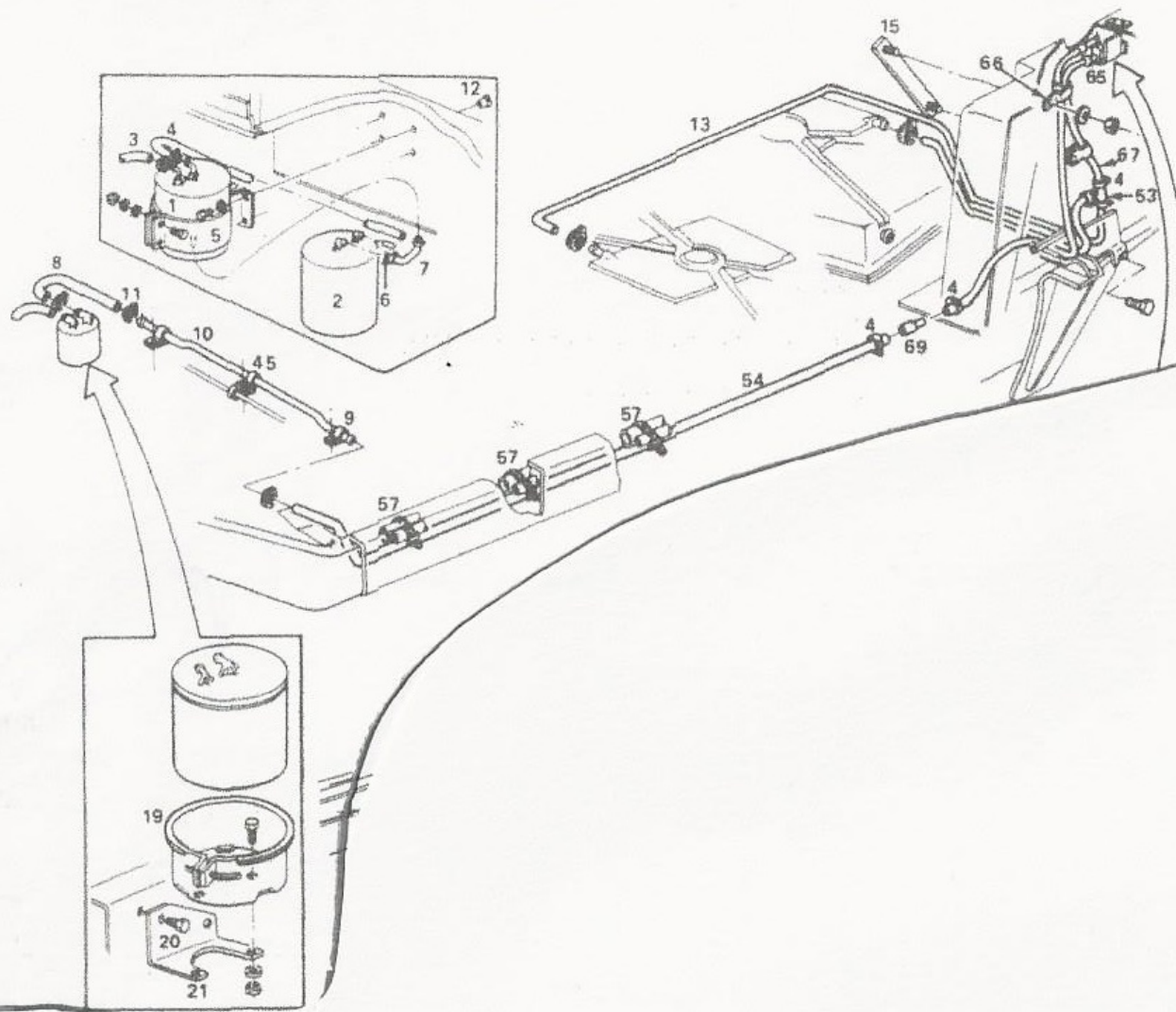

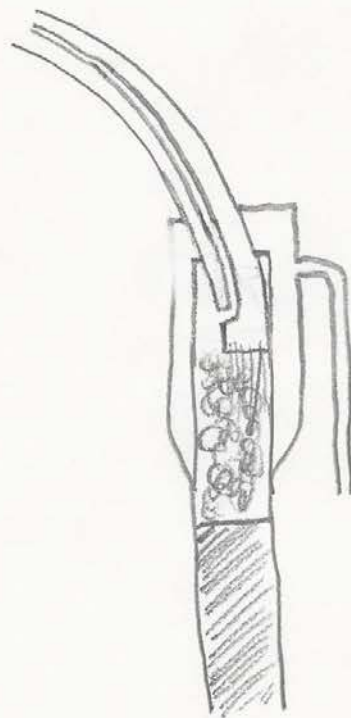
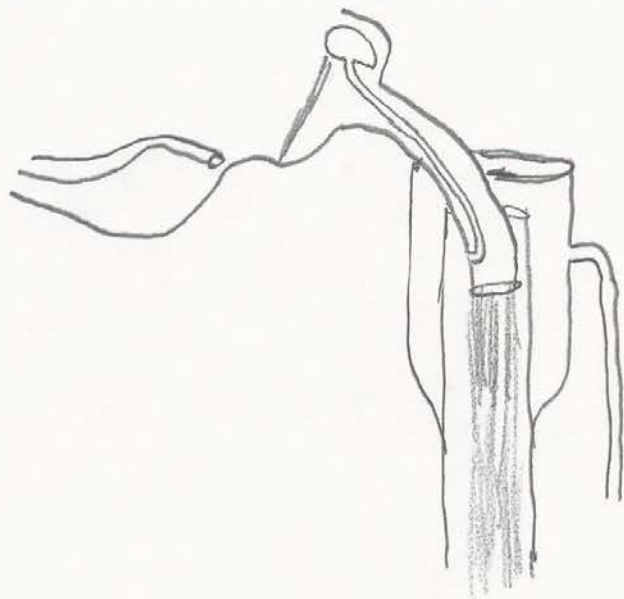

Air Filter Housing

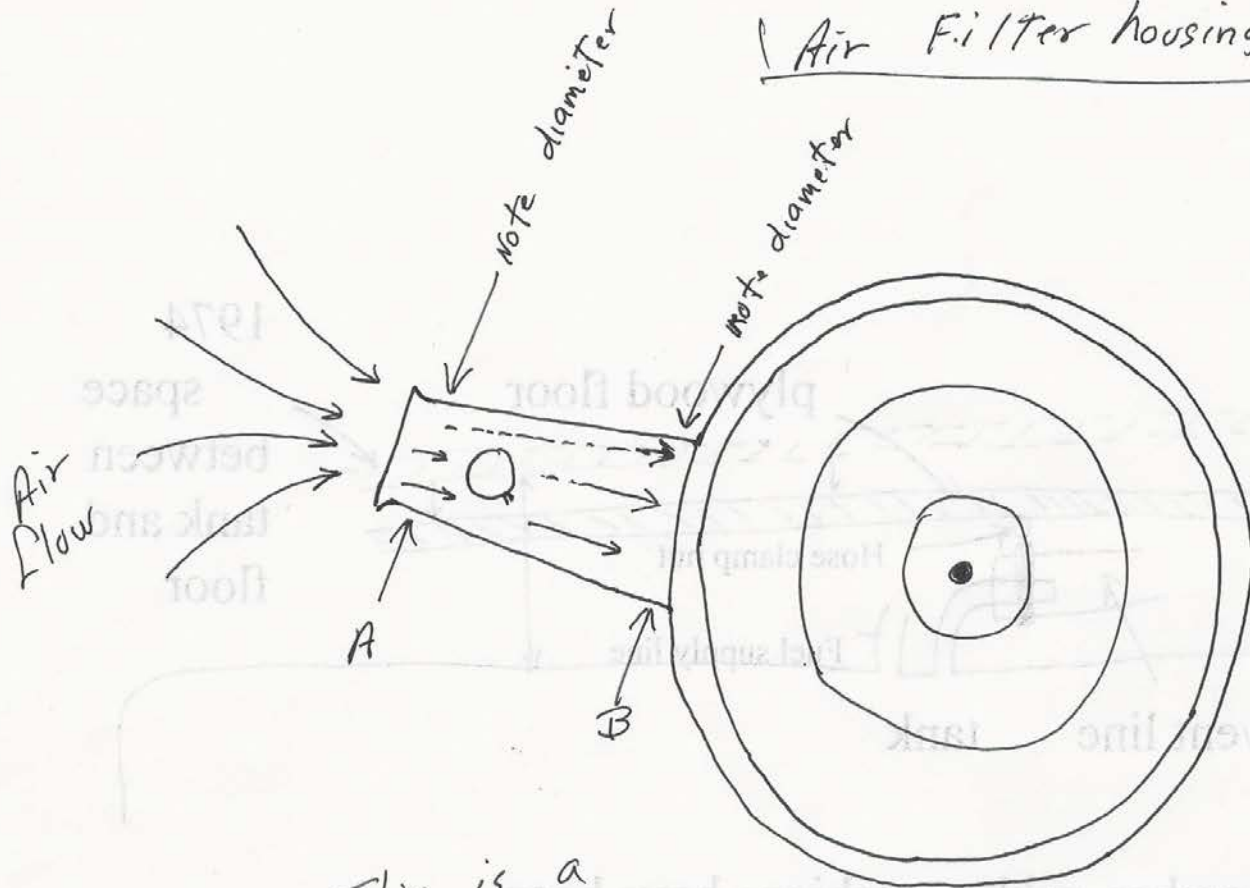

This is a
Venturi

Why is diameter A less than
diameter B?

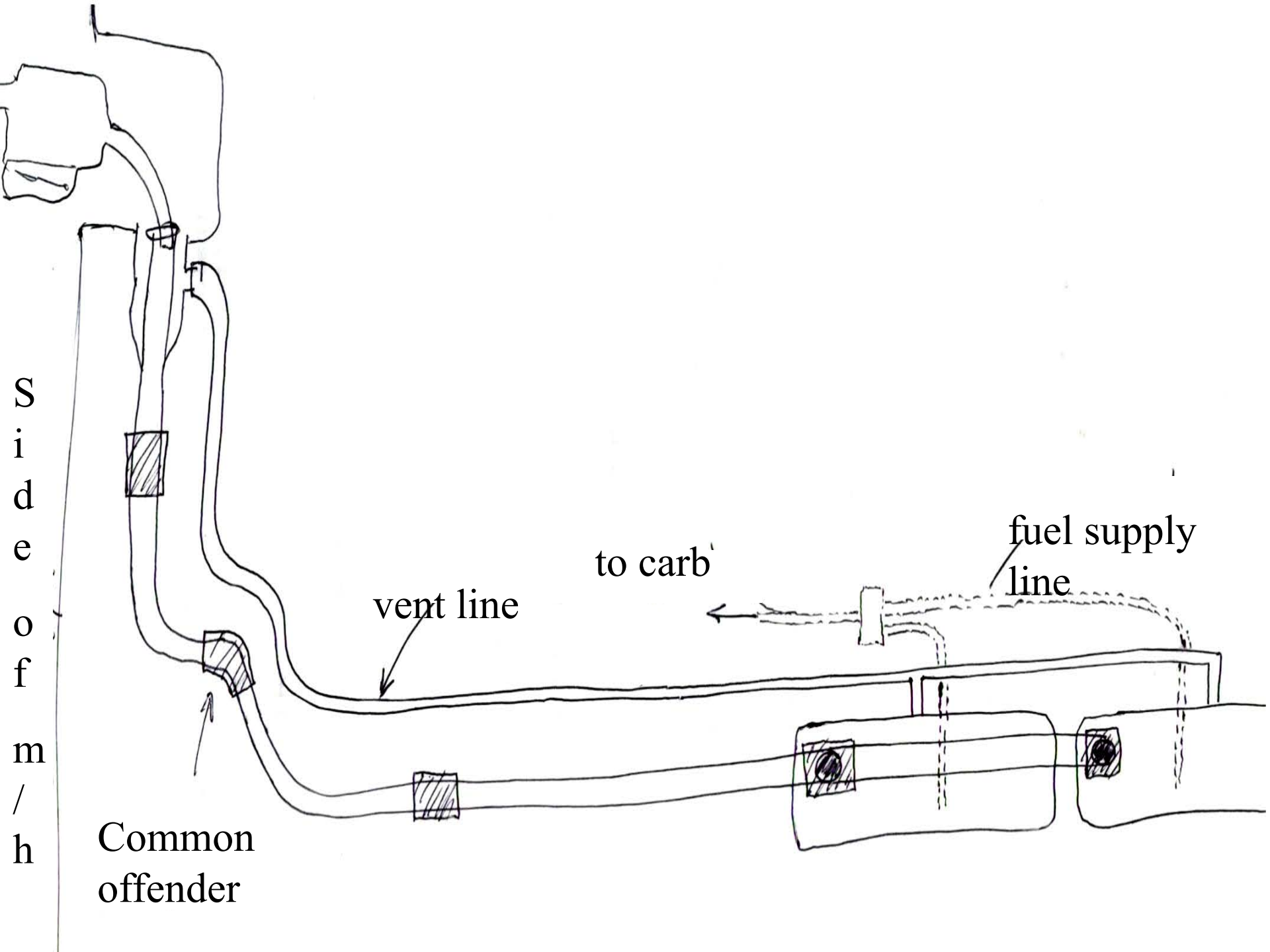

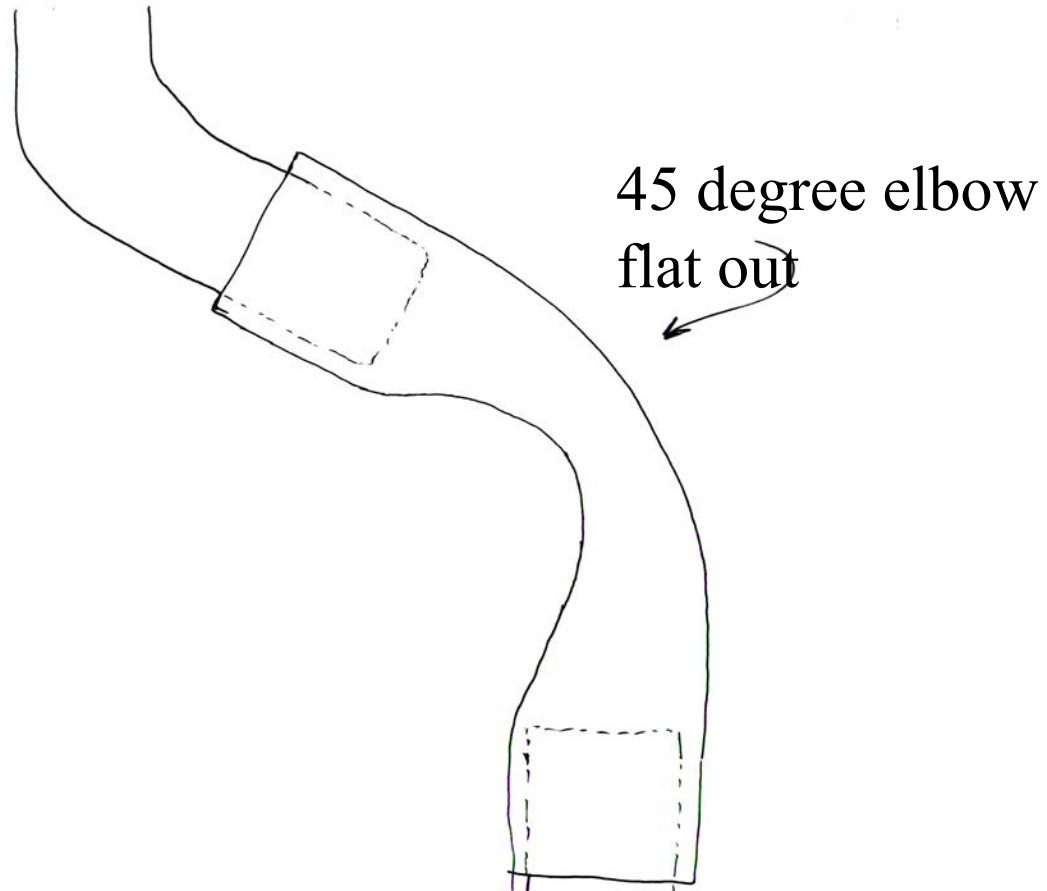

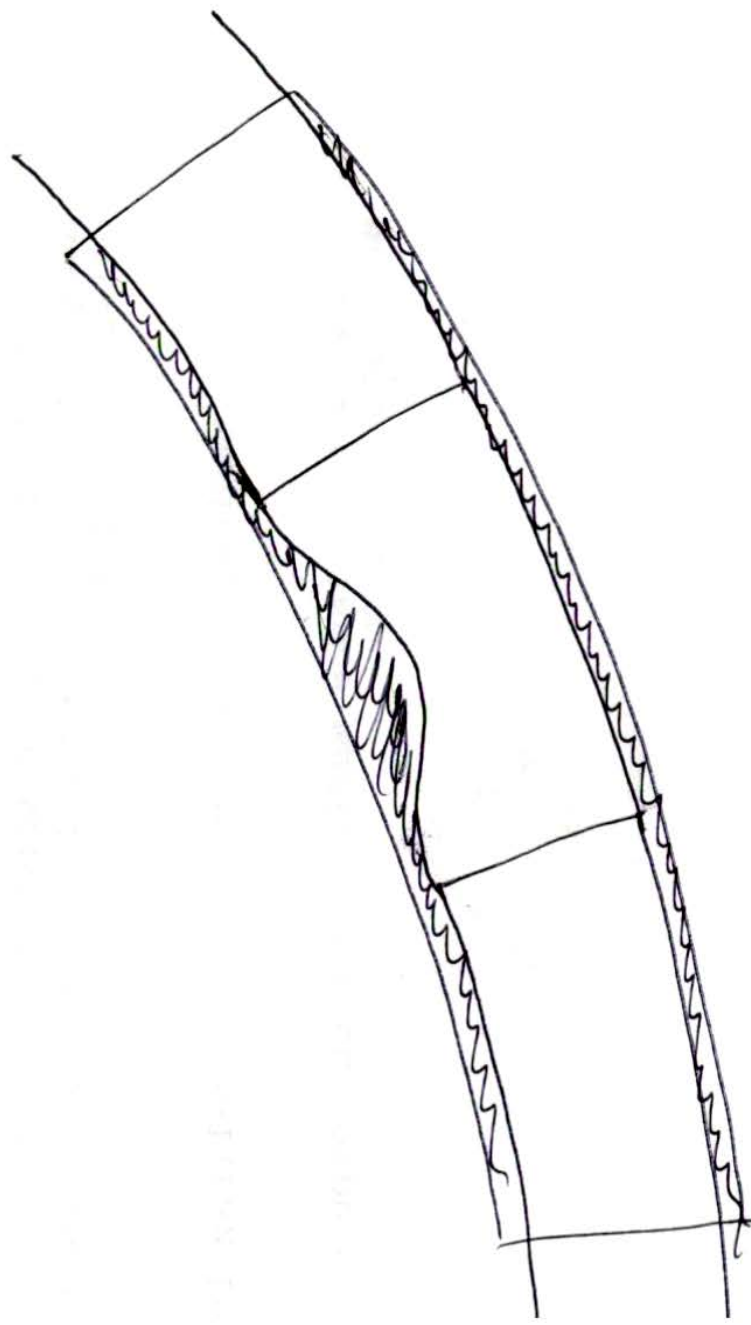
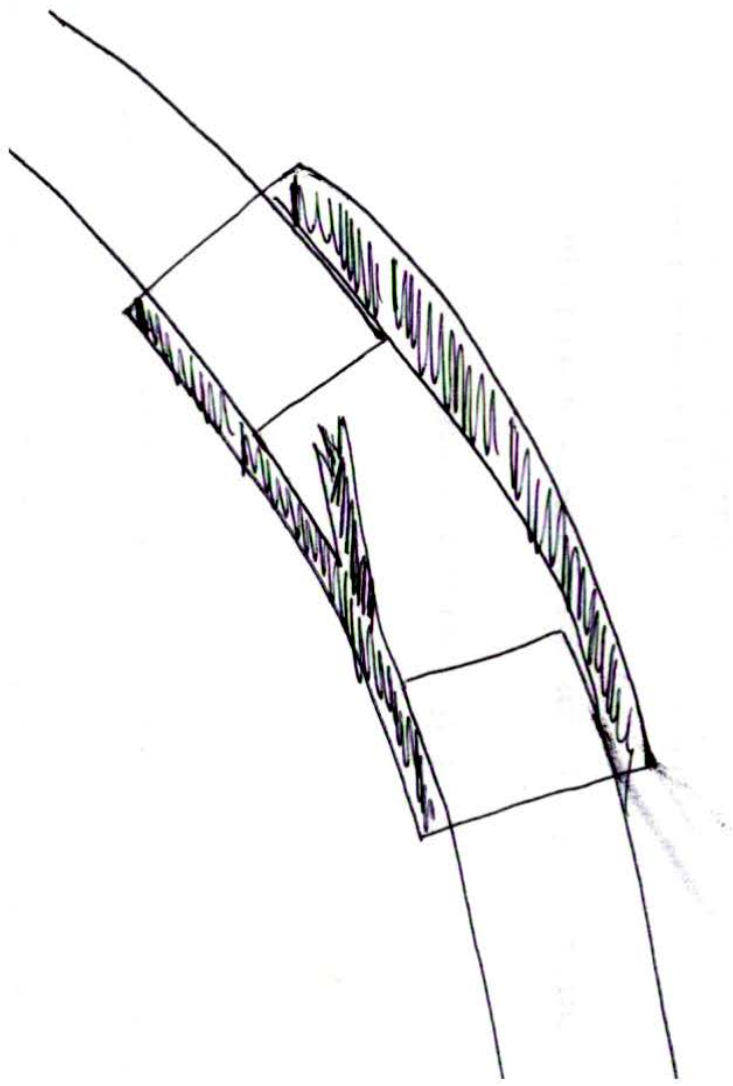

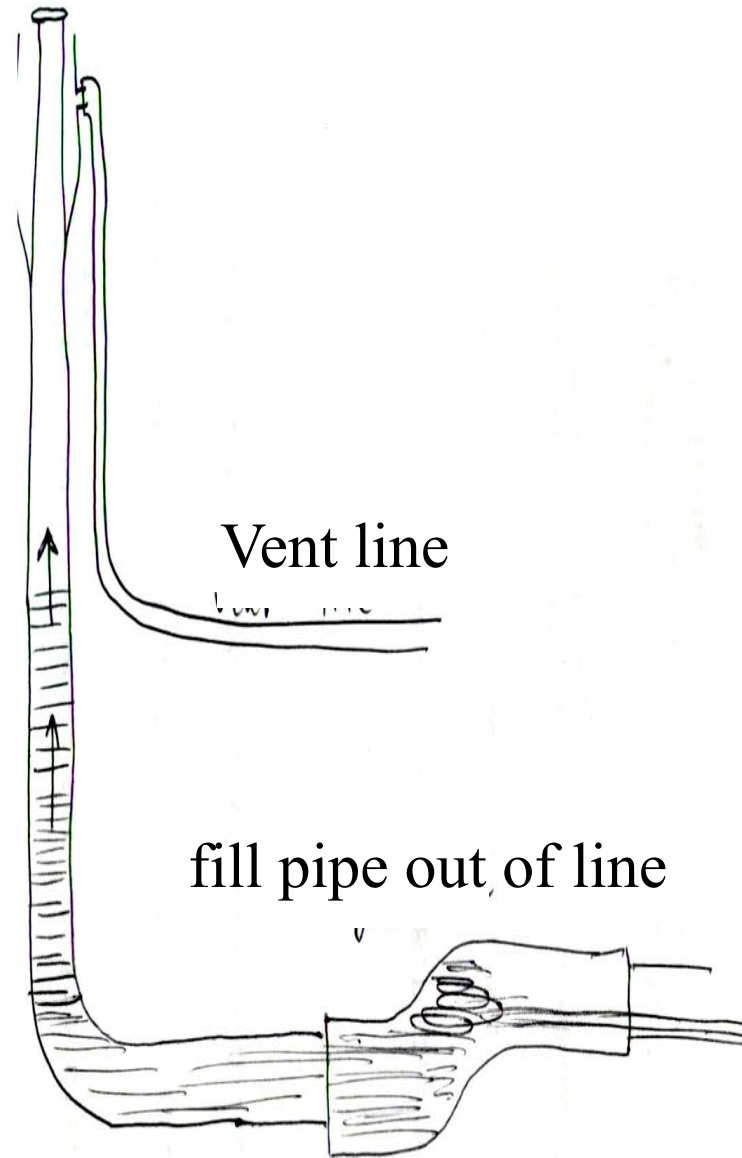

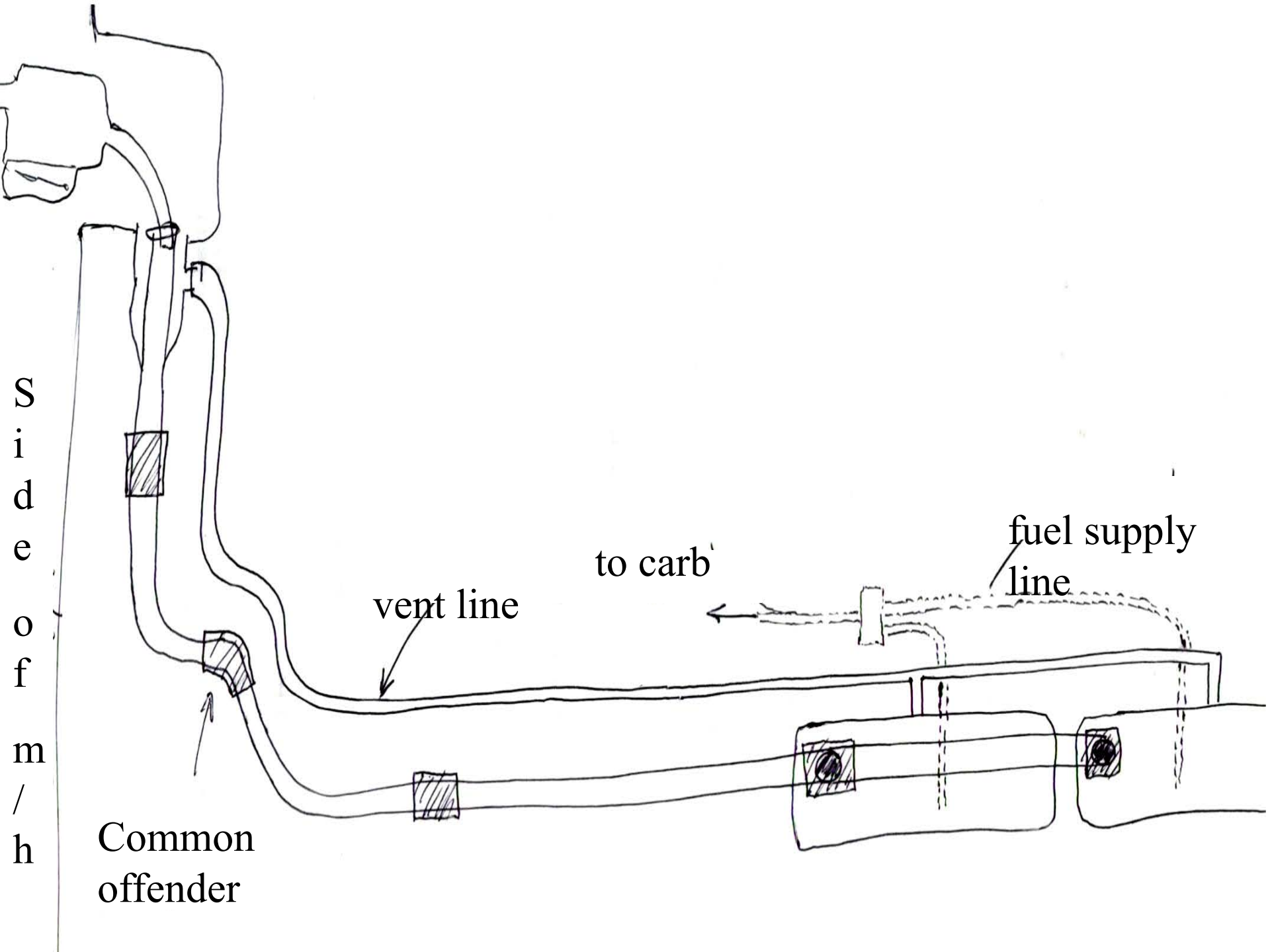

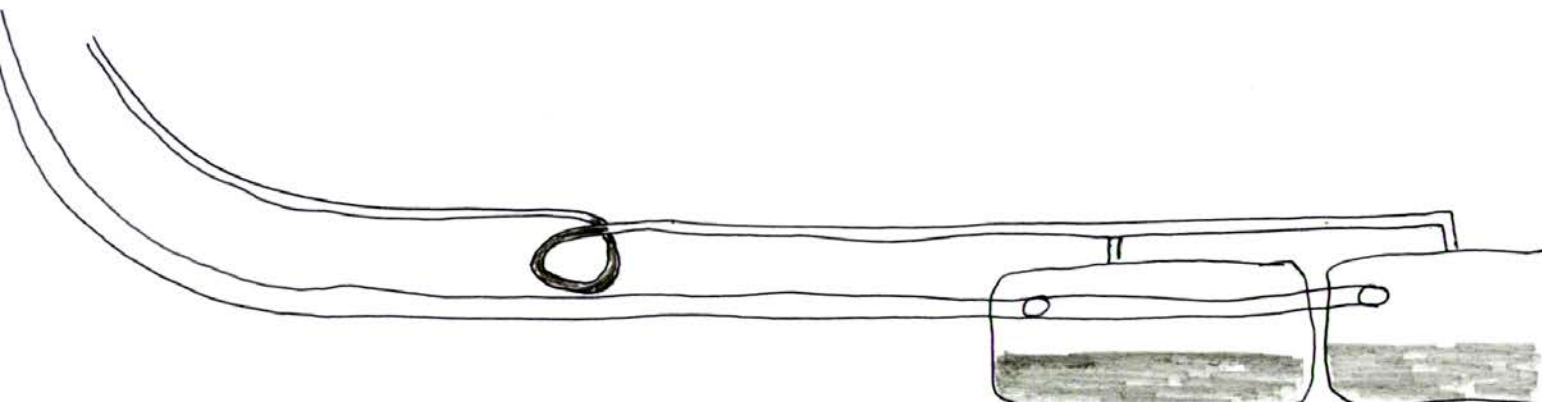
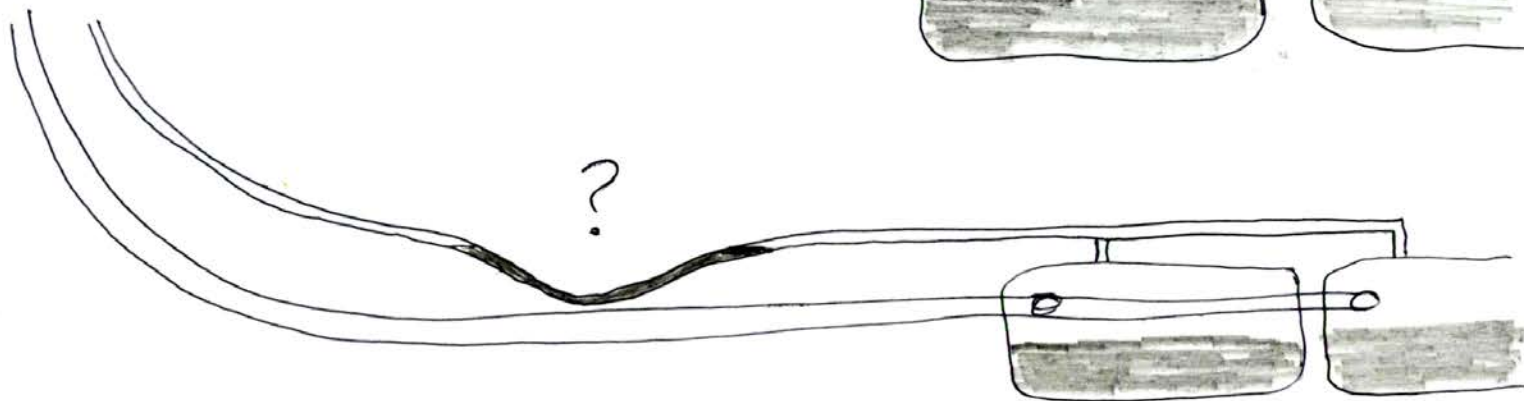
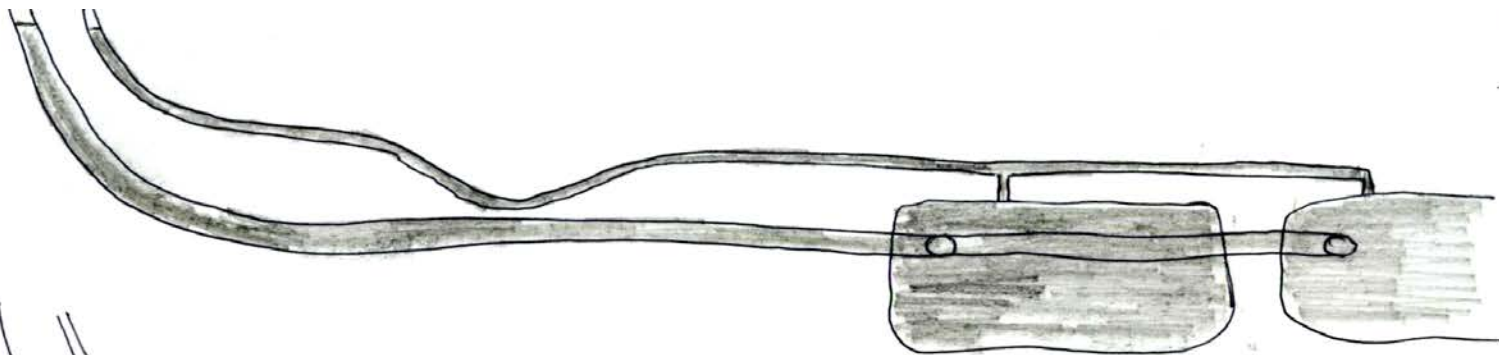

View down on top of tank

to carbon cannister

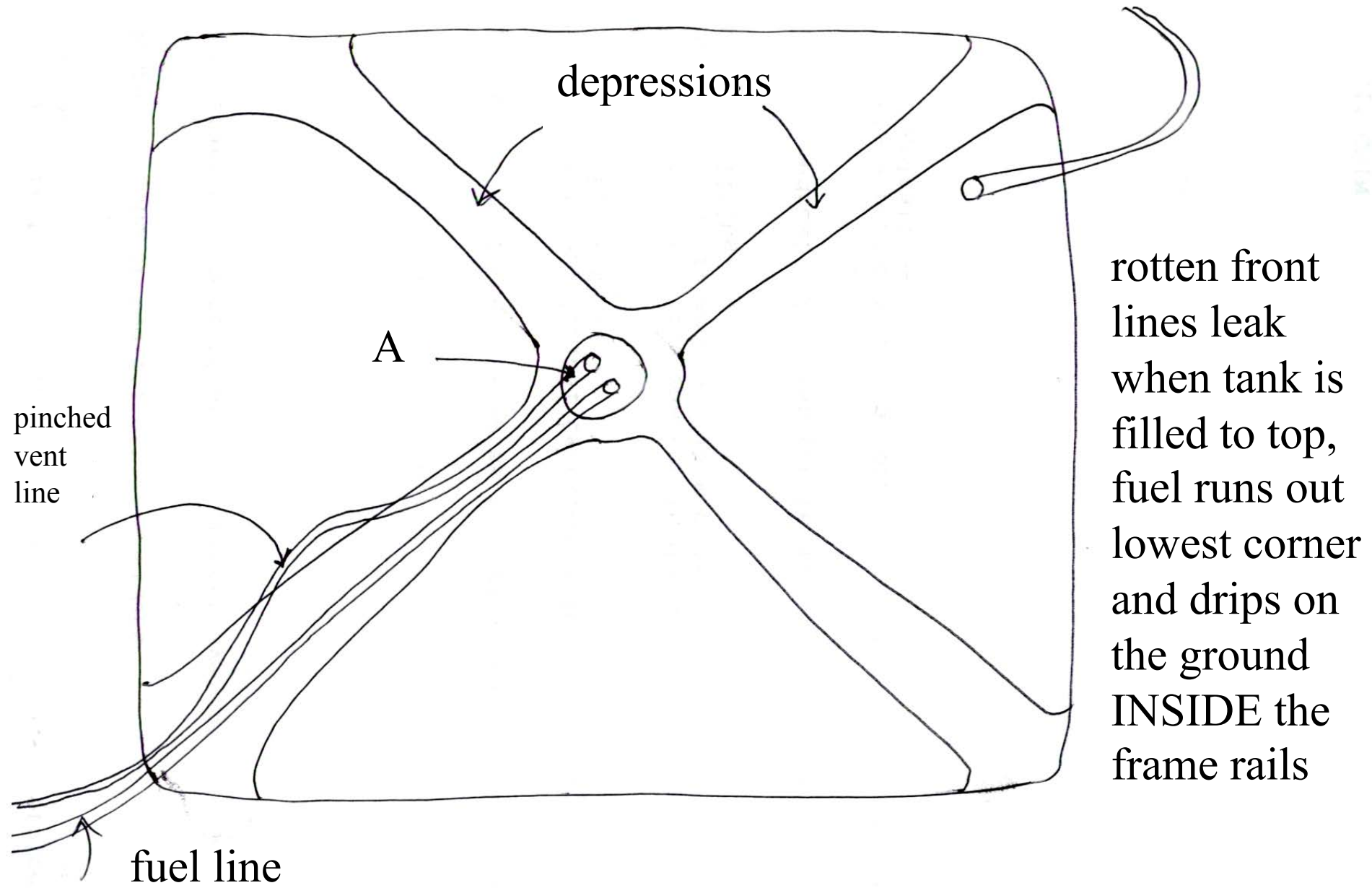

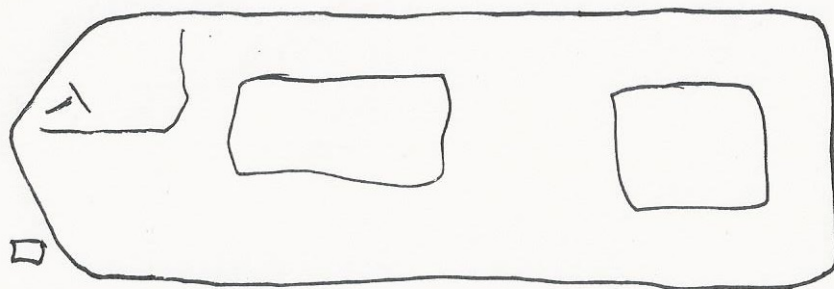

Body



Rubber pads

Frame Rails

B

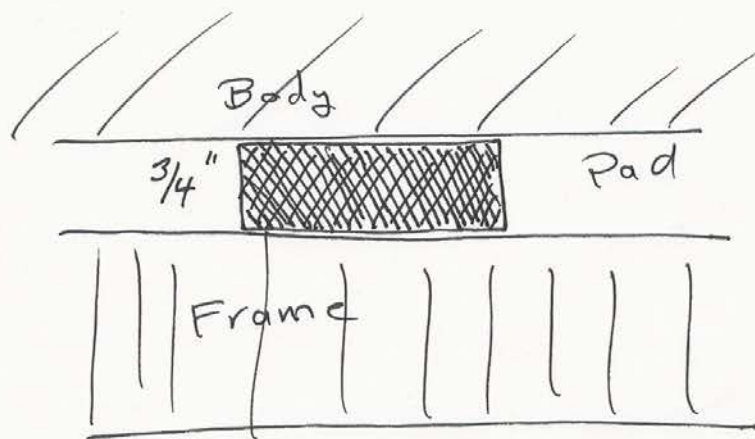

1974

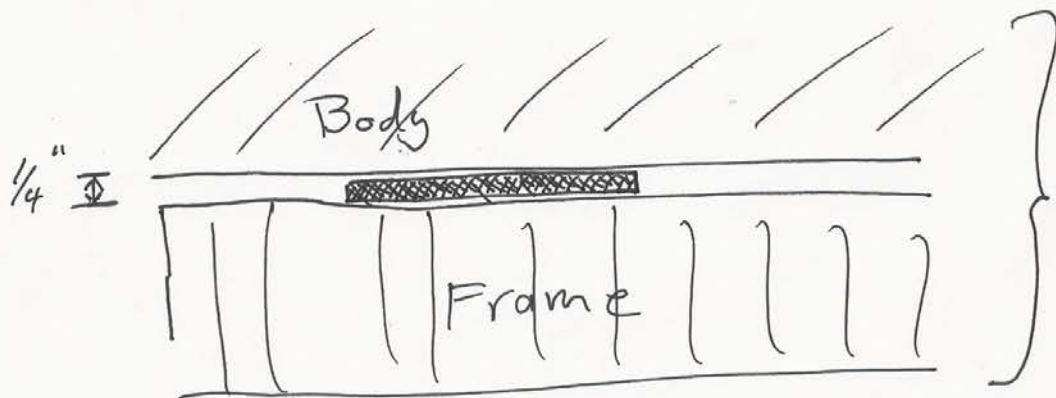

2016

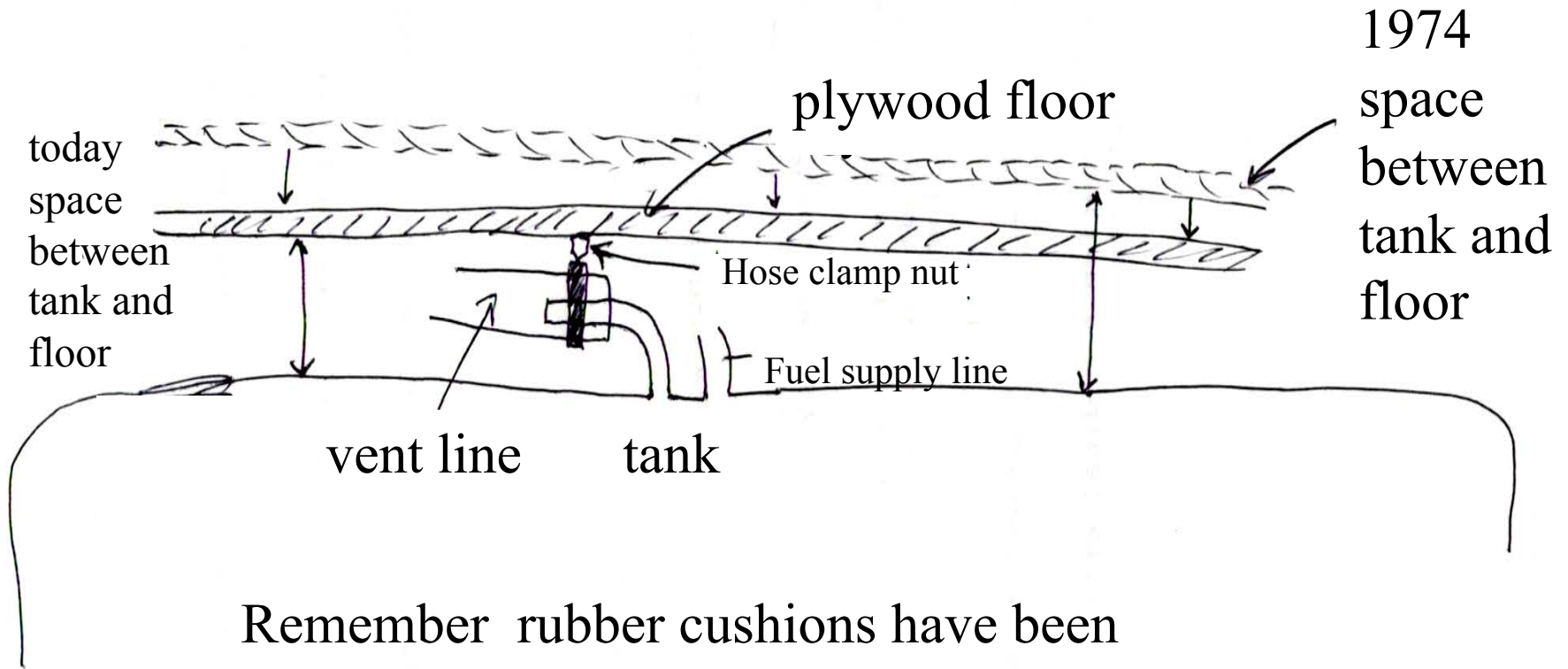

Remember rubber cushions have been squashed flat

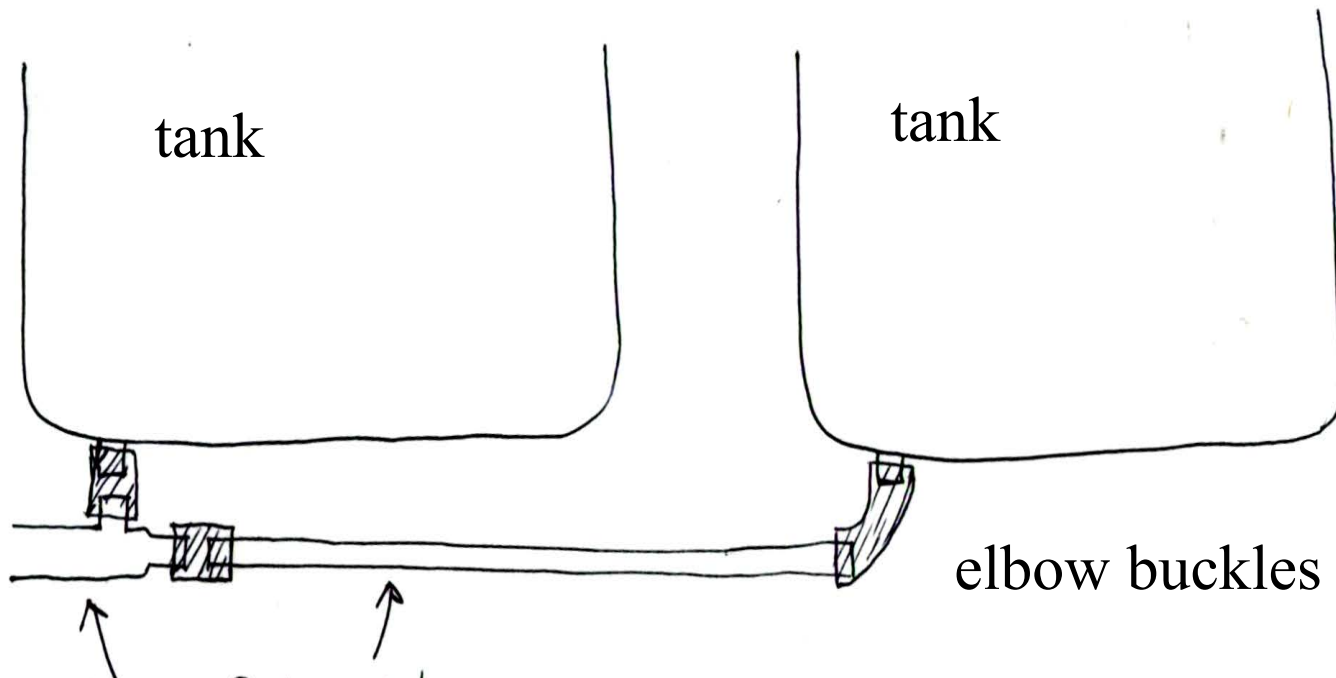

Steel filler tube

reduces in size at this junction
by $\frac{1}{4}$ "

Top view of tank

Properly Functioning and Adjusted Air Suspension System

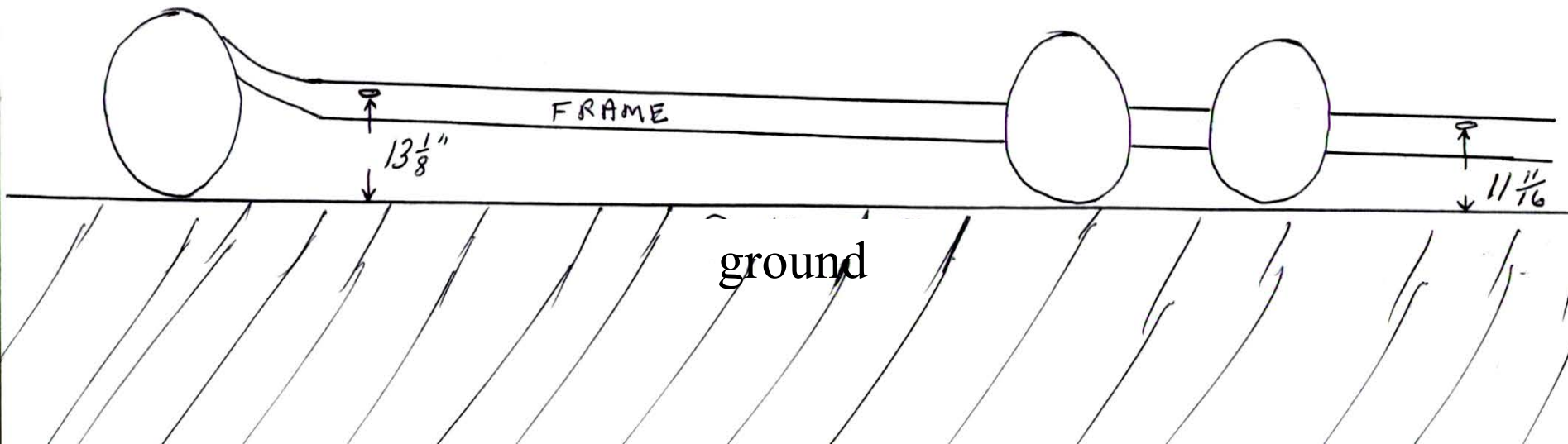

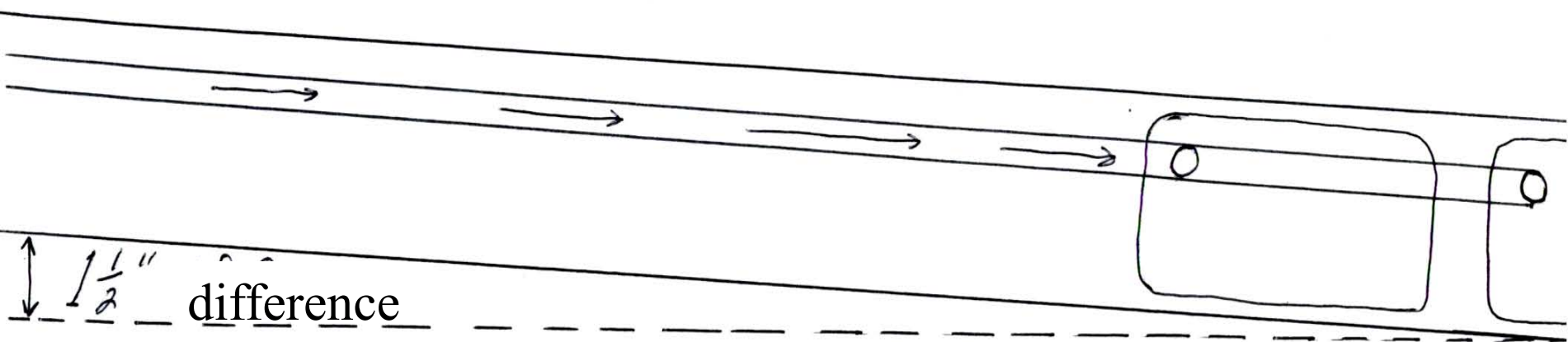

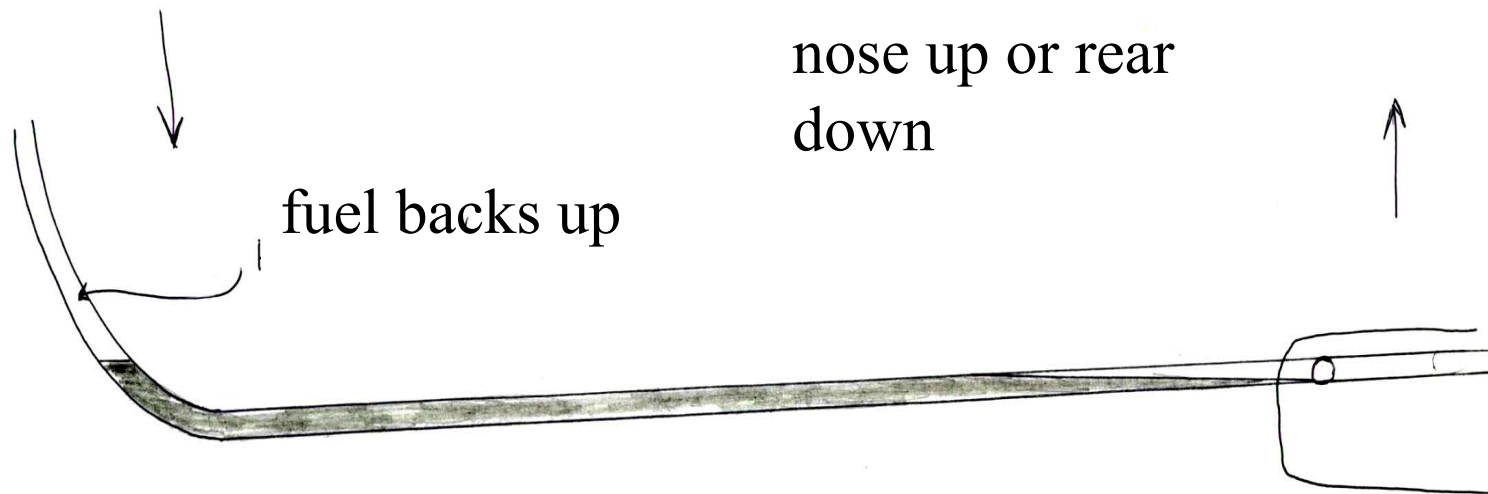
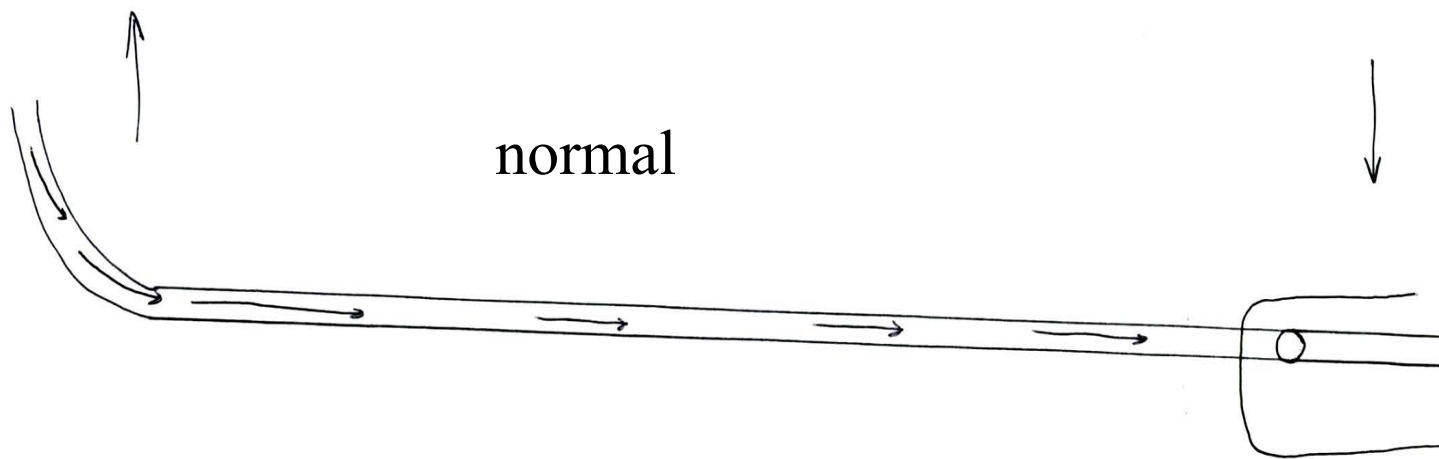

1. obstruction at rubber jct compounds problem
2. other fleets have same problem

Top down view

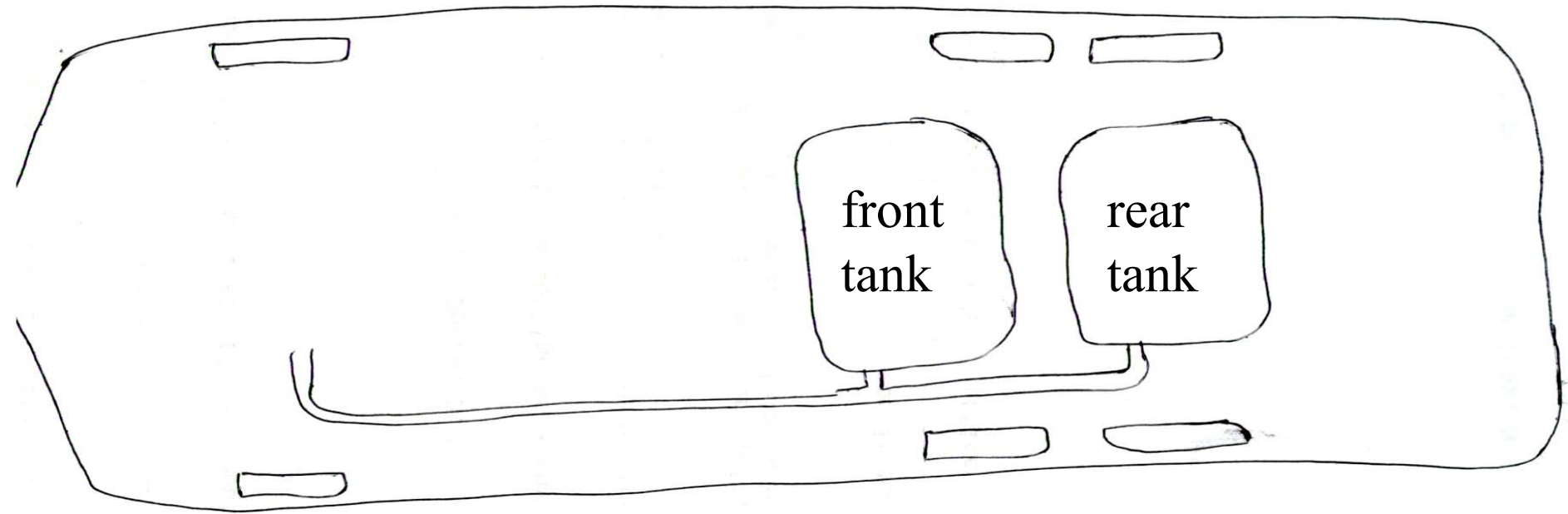

Side view

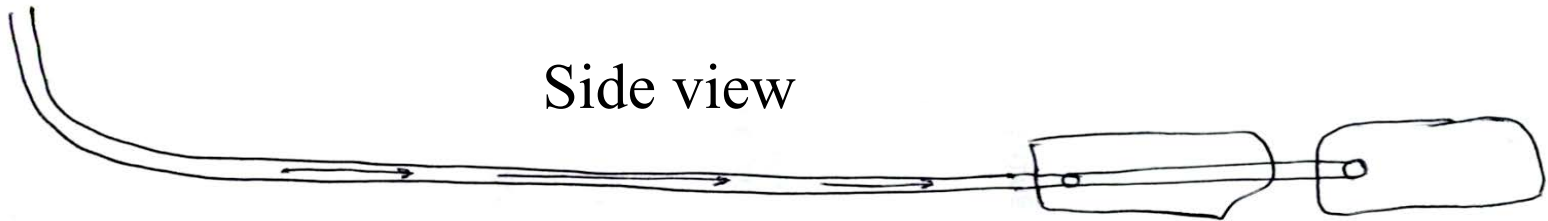

normal

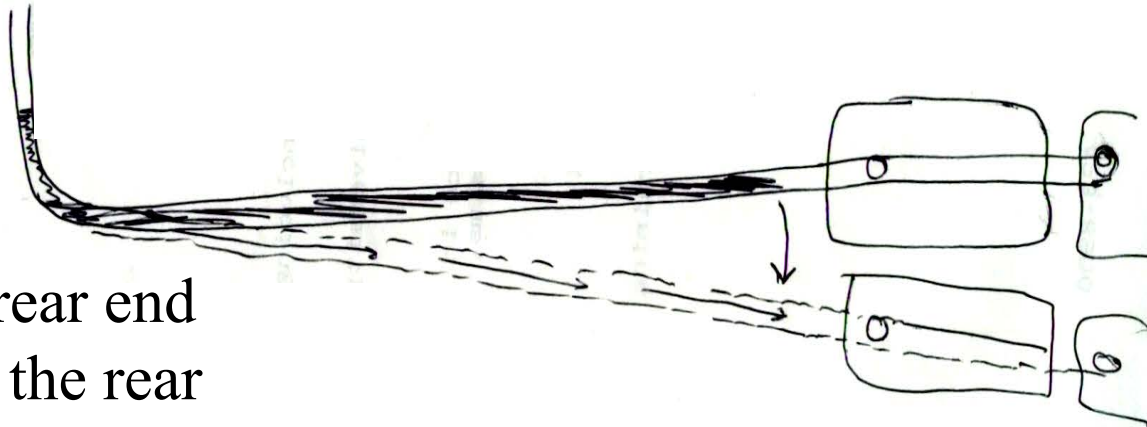
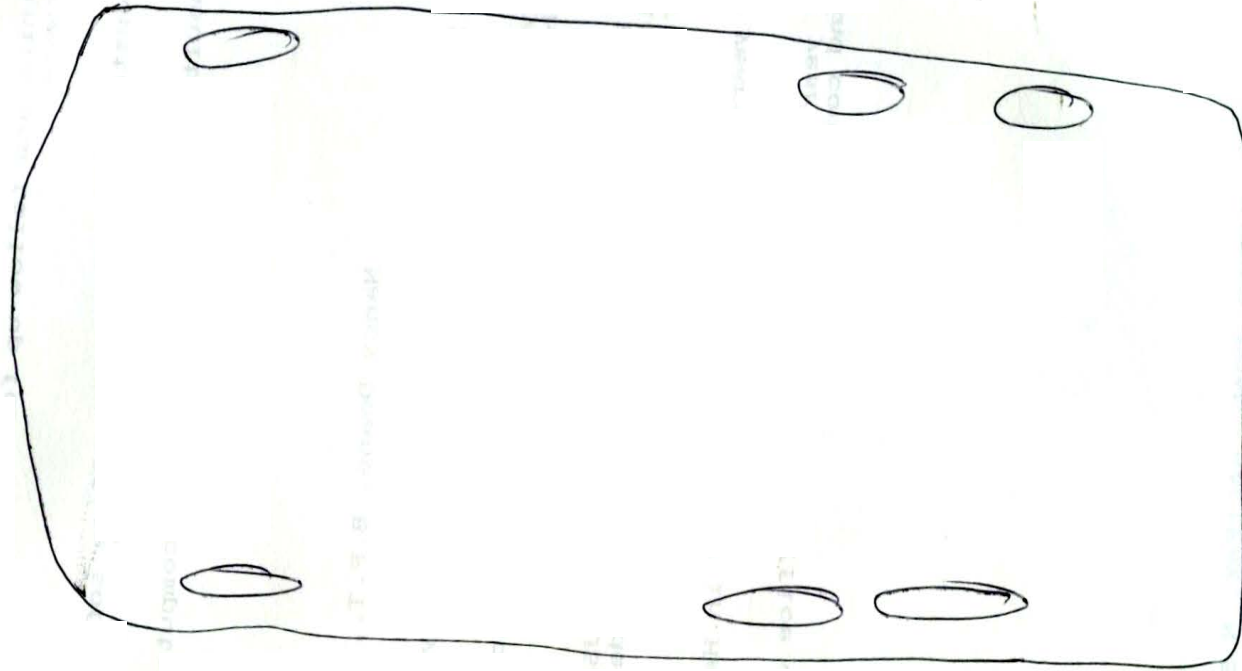

Elevated rear end
now drop the rear

right

point A
nonadjustable fixed
point

drop this airbag 4 1/2", side
goes down and whole m/h
rocks on points A and B

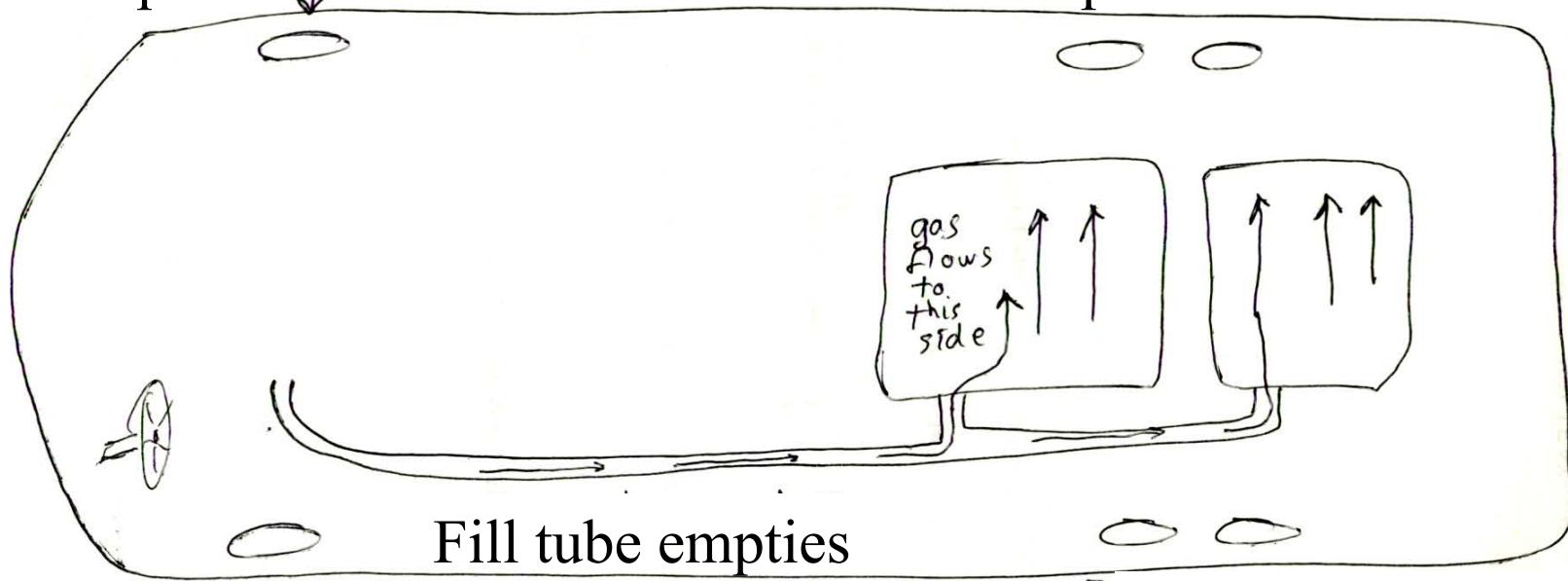

left

this point goes up approx
3 1/2 "

Fill tube empties

fix this airbag
side ↓

the difference created
is approx 7 to 8"

pivot point
point B

Fuel/vaporizer
separator valve

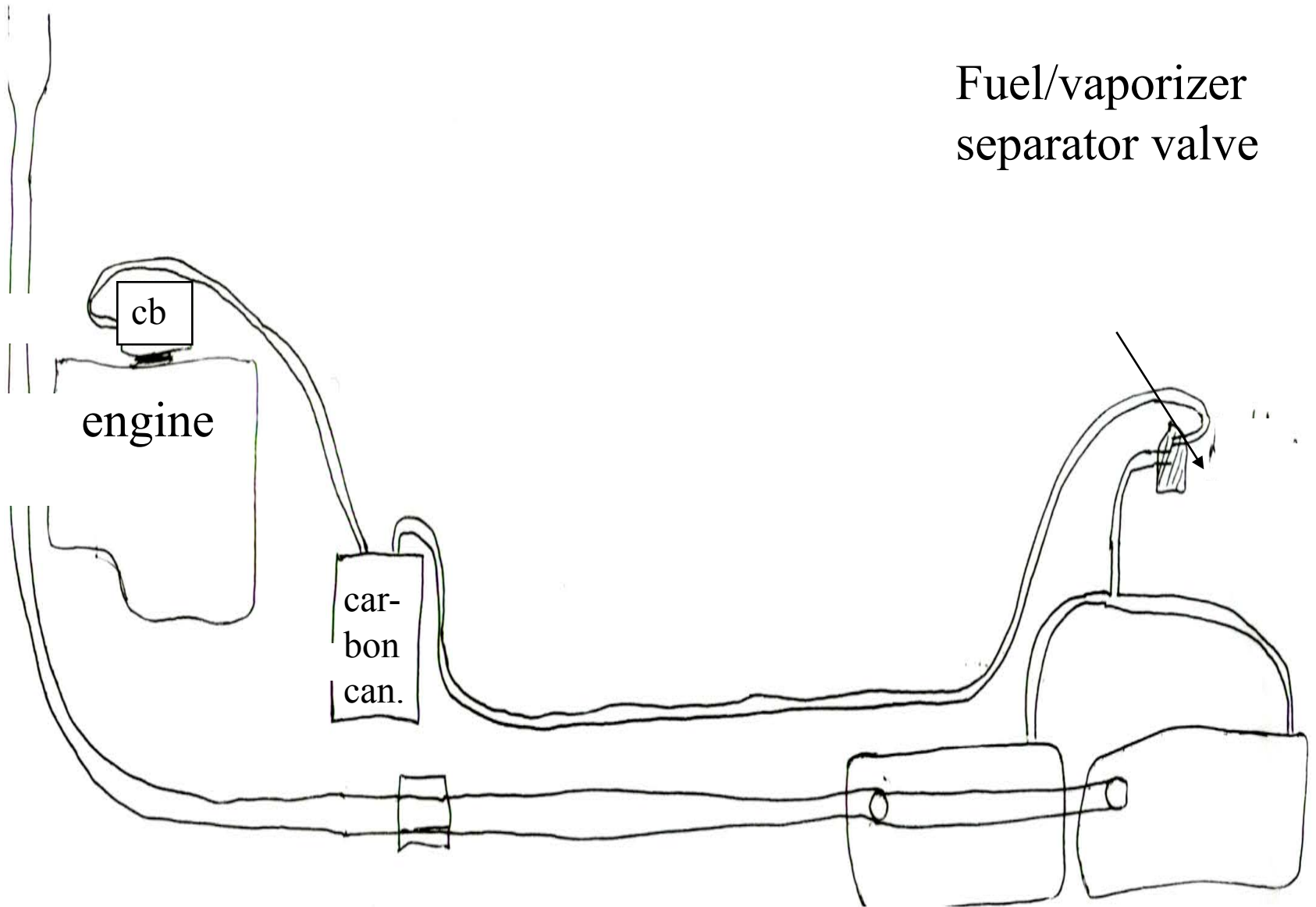

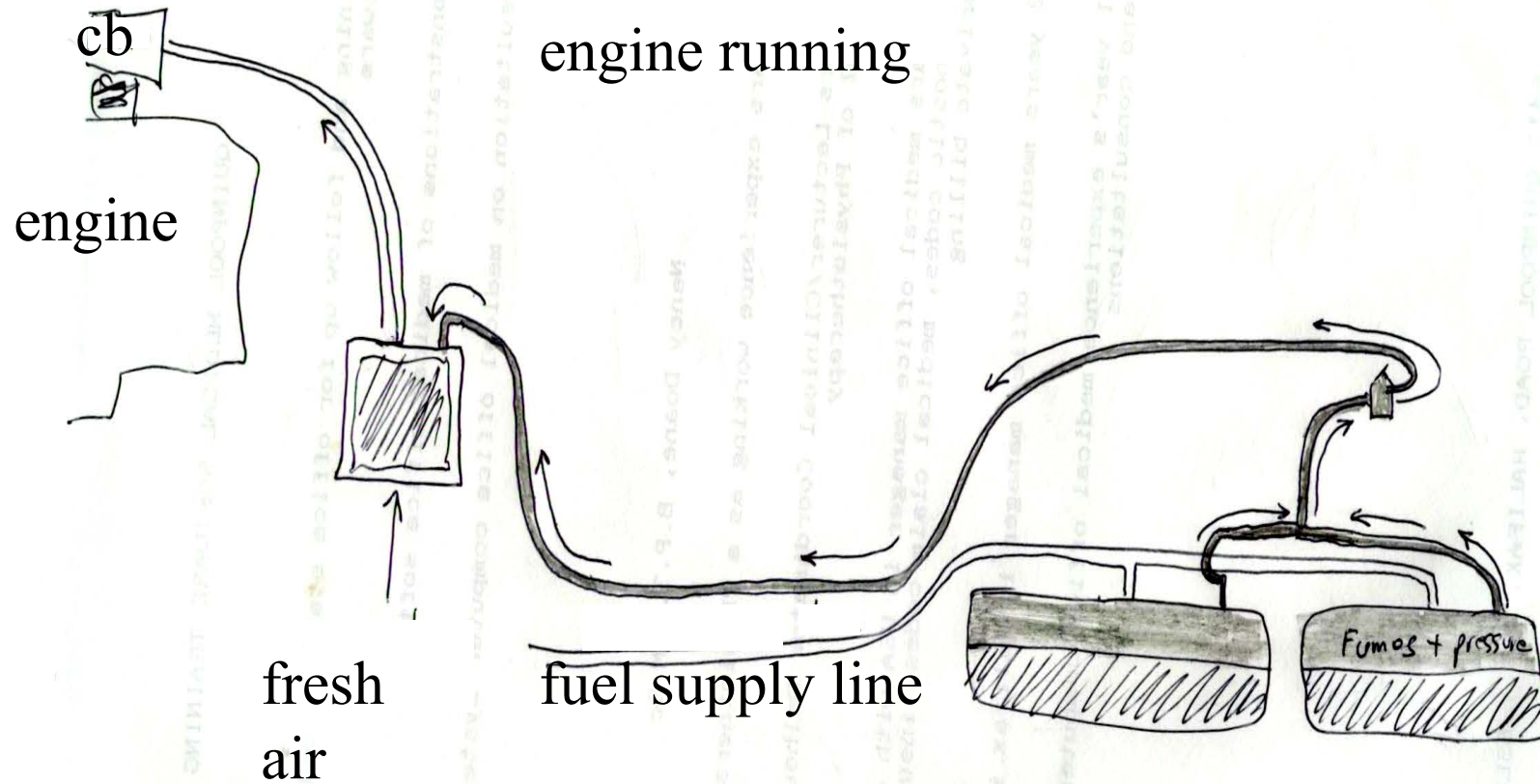

Engine just stopped

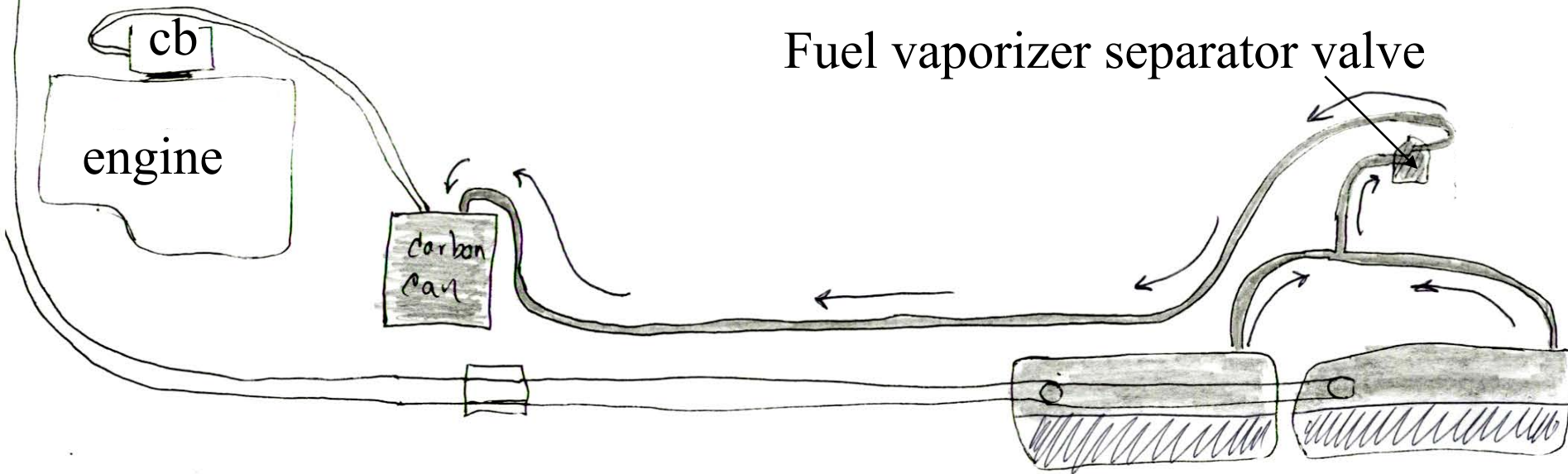

gasoline vapor adsorbed by activated charcoal

Gasoline fumes
into cockpit

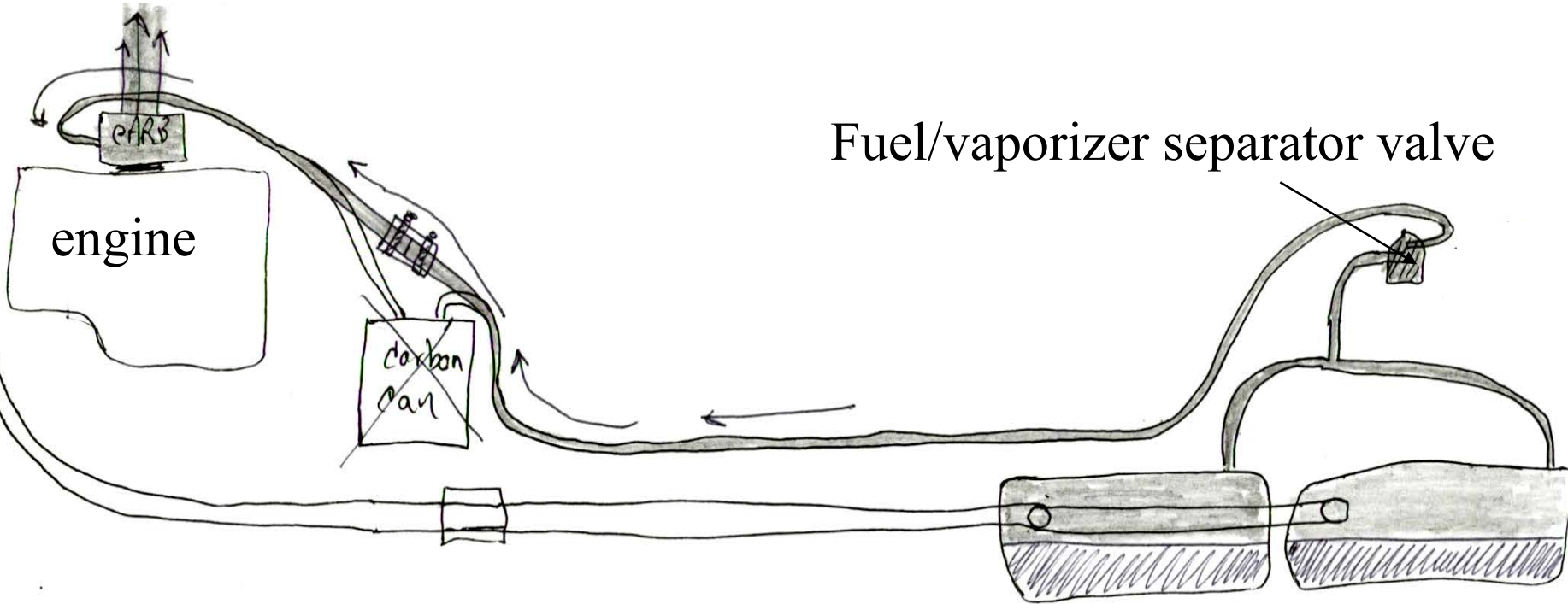

Engine stopped, no carbon canister

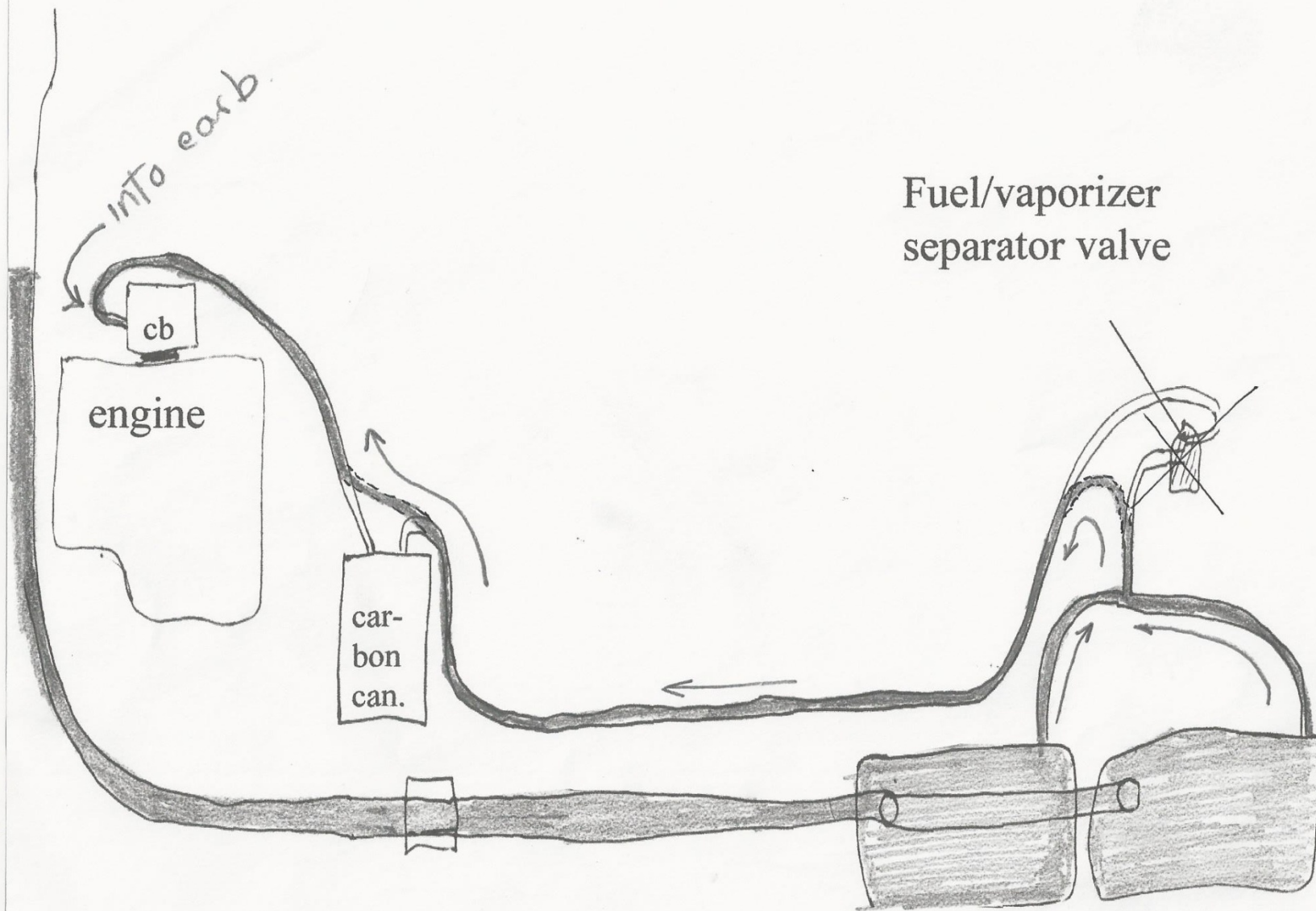

T

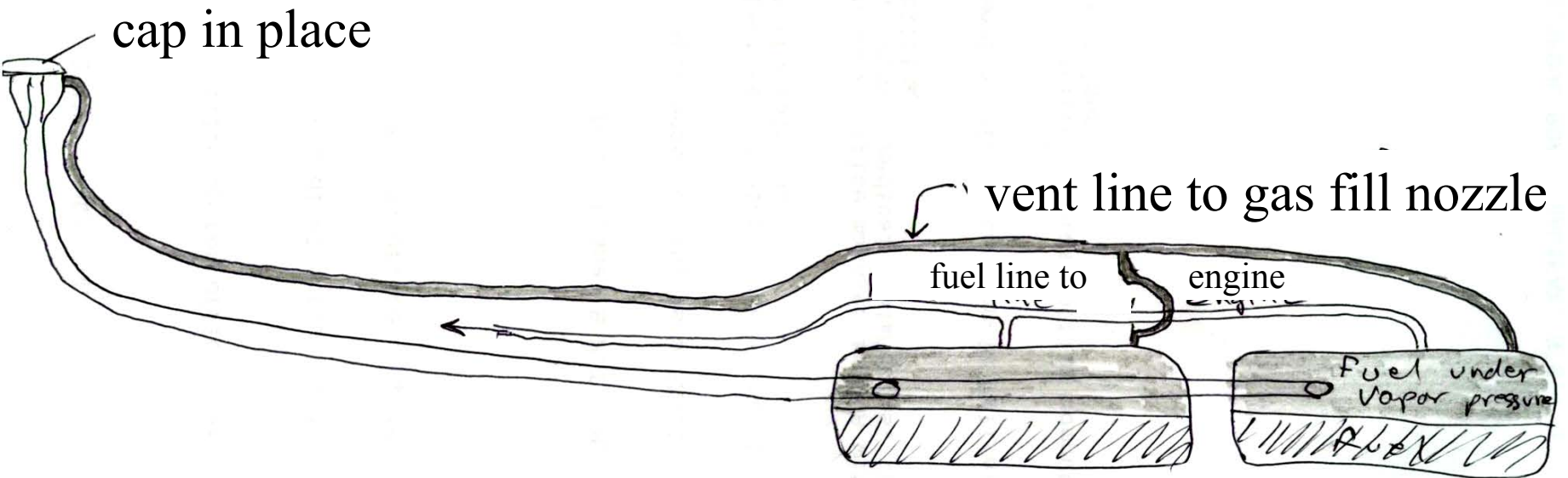

Carbon canister, fuel /vaporizer separator and lines all removed

Problem # 1 - broken vent line leads to leakage outside rails

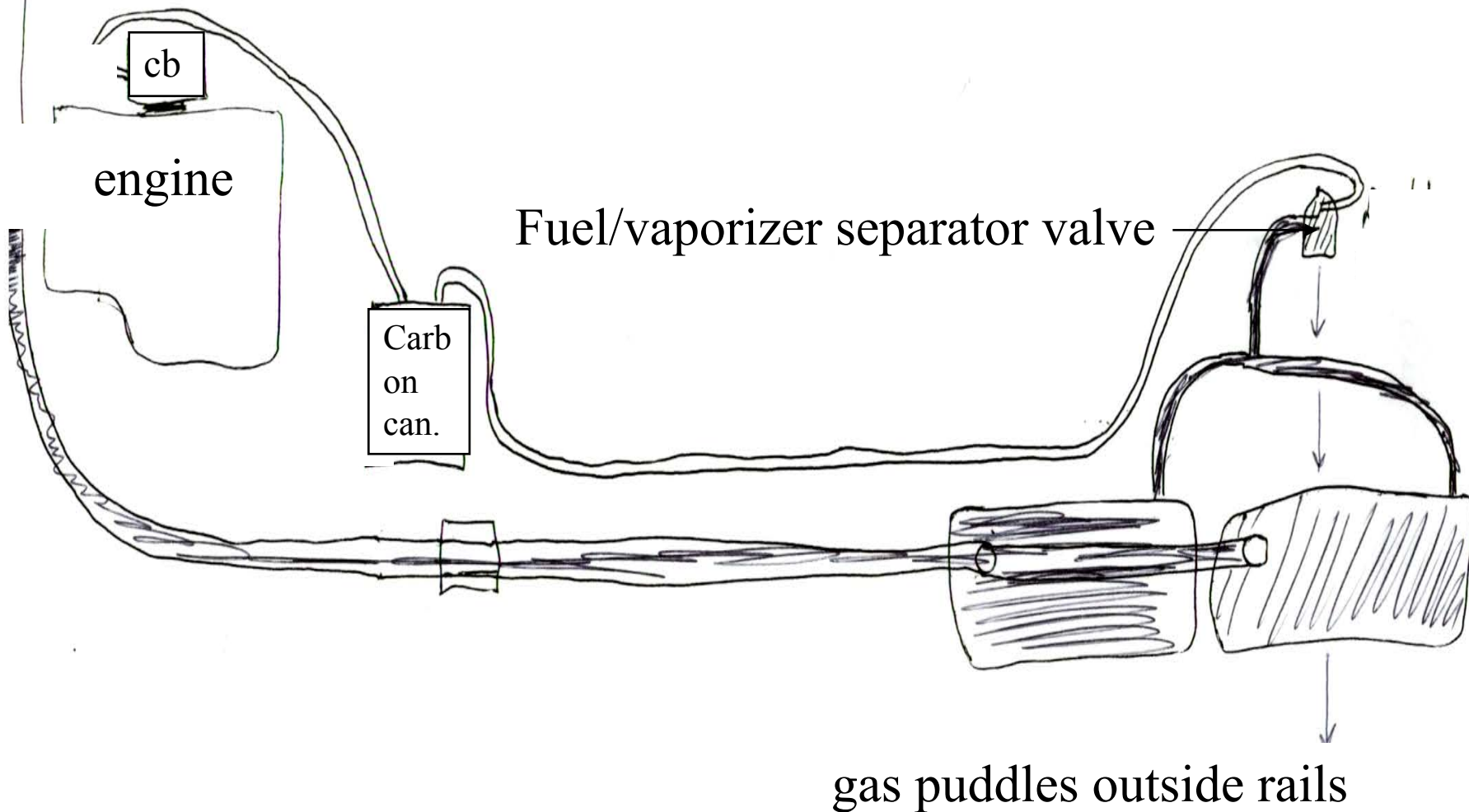

Problem # 2 - separator valve failure

Problem # 3 - separator valve removed
leads to same result

