

**GMC**

**MOTOR HOME**

**SELECTOR**

**FLOOR PLANS**

**FRONT**

## Floor Plans

This section contains all the floor plans that are available for the MotorHomes. Since the floor plans consist of individual modules, a description of each is furnished to help you with the customer in making a proper selection. Each floor plan and selection of module has certain advantages for different size family groups and different basic usages that the MotorHome might be subjected to.

Photographs will be incorporated in this section and new pages will be furnished to you by March 1.

## **Double Dinette - Right Side**

Available in floor plans 26-1 BQH, 26-2 BQJ, 26-3 BQK, 26-4 BQL, 26-5 BQM, 26-6 BQN, 26-7 BRE, 26-8 BQP, 26-9 BQQ.

The double dinette mounted on the right side of the vehicle on 26' models offers convenient seating for four adults. It serves as the dining area as well as a comfortable traveling position. In the evening, it serves as an entertainment center. For sleeping, it easily is converted into a double bed.

## **Double Dinette - Left Side**

Available in floor plans 23-1 BQT, 23-2 BQU and 23-3 BQV.

The double dinette mounted on the left side of the vehicle on 23' models offers convenient seating for four adults. It serves as the dining area as well as a comfortable traveling position. In the evening, it serves as an entertainment center. For sleeping, it easily is converted into a double bed.

## **Davo - Left Side**

Available in floor plans 26-1 BQH, 26-2 BQJ, 26-3 BQK, 26-10 BQR and 23-4 BQW.

The left hand davo offers seating for three adults. It also serves part of the entertainment center for those leisure hours. At night, it converts to upper and lower bunks for individual sleeping comfort.

## **Auxiliary Dinette - Left Side**

Available in floor plans 26-4 BQL, 26-5 BQM, 26-6 BQN.

Designed to complement the double dinette, the single dinette on the left side of the motorhome offers additional space for serving meals or entertaining. At night, it converts to a single bed.

## **Swivel Chair - Left Side**

Available in floor plans 26-7 BRE, 26-8 BQP, 26-9 BQQ and 26-11 BQS.

For the ultimate in seating comfort, high-backed swivel chairs are available for traveling or entertaining. A specially designed fold-out table is mounted on the wall for use in serving light snacks or beverages.

## **Davo - Right Side**

Available in floor plans 26-10 BQR and 26-11 BQS.

The davo on the right side provides a floor plan resembling twin beds when used with the left davo in 26-10 BQR. It offers comfortable seating for three adults and easily converts into bunk beds for sleeping.

## **Rear Compartment - Double Bed**

Available on floor plans 26-1 BQH, 26-4 BQL, 26-7 BRE, 23-1 BQT.

For the ultimate in sleeping comfort, the full double bed rear module is included. It offers a storage compartment under the bed for those seldom used but necessary items.

## **Rear Compartment - Goucho**

Available in floor plans 26-2 BQJ, 26-5 BQM, 26-8 BQP, and 23-2 BQU.

A full width couch called a goucho provides comfortable forward-facing seating for three adults. It quickly converts into a double bed for sleeping. It gives the necessary flexibility for entertaining large groups.

## **Rear Compartment - Side-Facing Settee - Rear Dinette**

Available in floor plans 26-3 BQK, 26-6 BQN, 26-9 BQQ, 26-10 BQR, 26-11 BQS, 23-3 BQV and 23-4 BQW.

The side-facing settee layout in the rear compartment offers comfortable seating for four adults. When the table is placed between the facing seats, it offers an excellent separate area, especially for children.

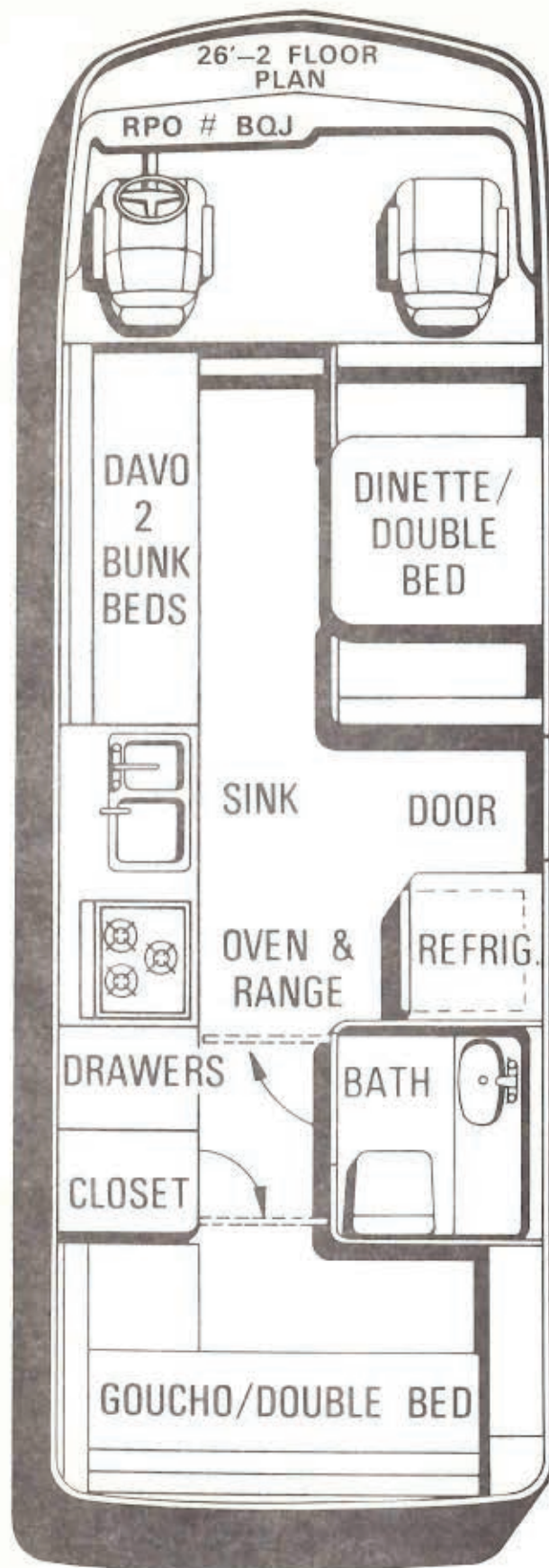
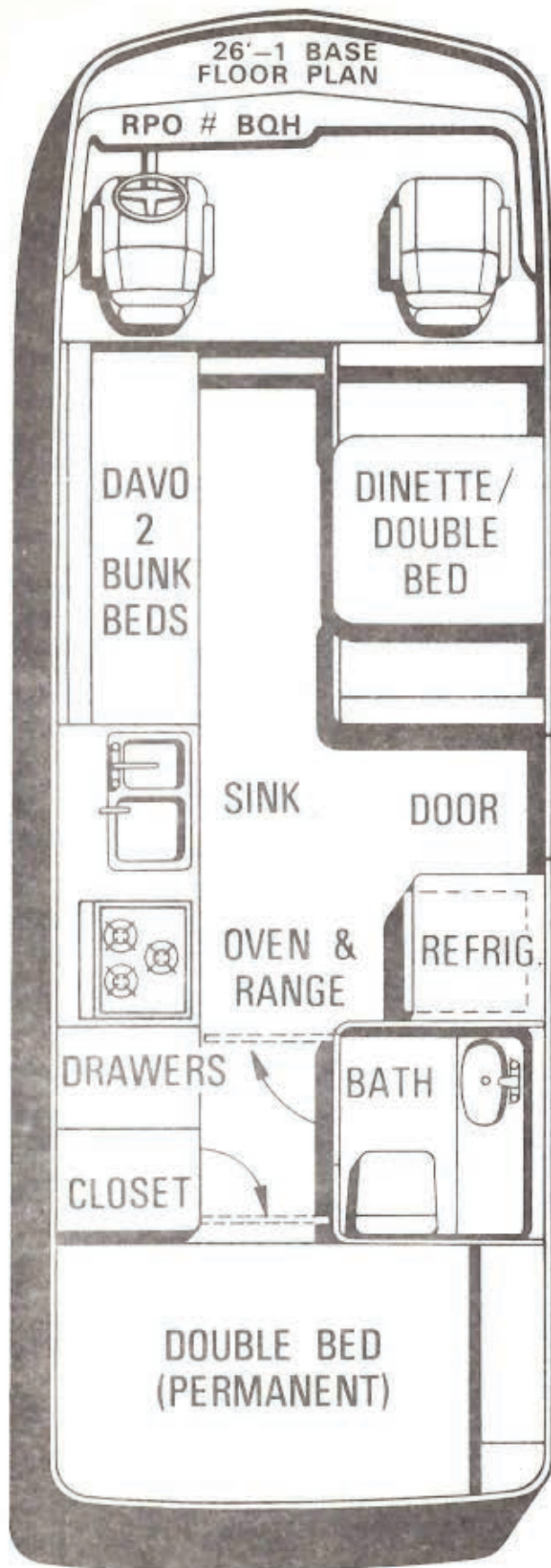

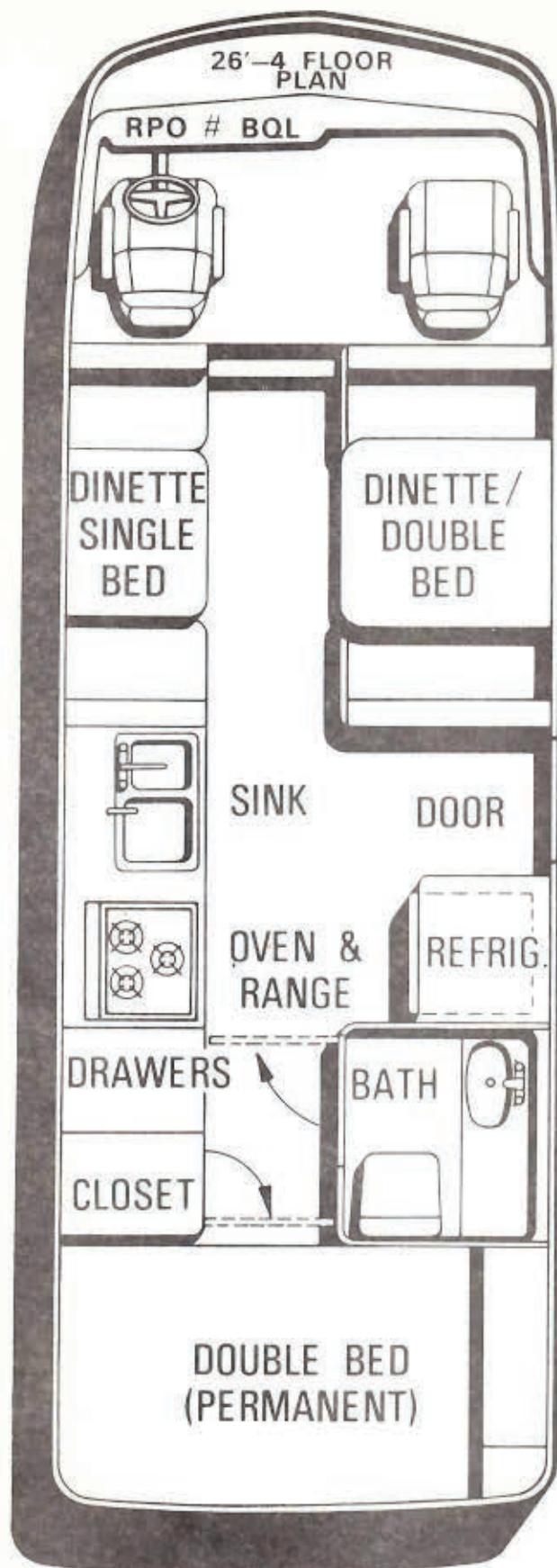
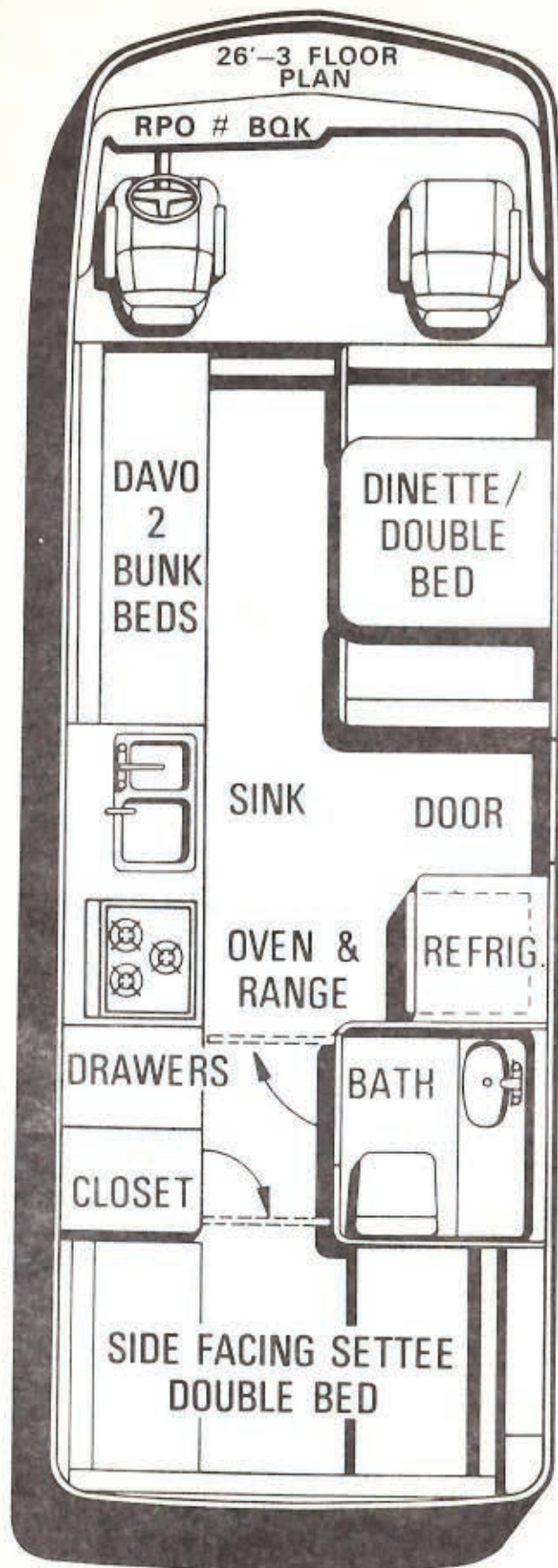

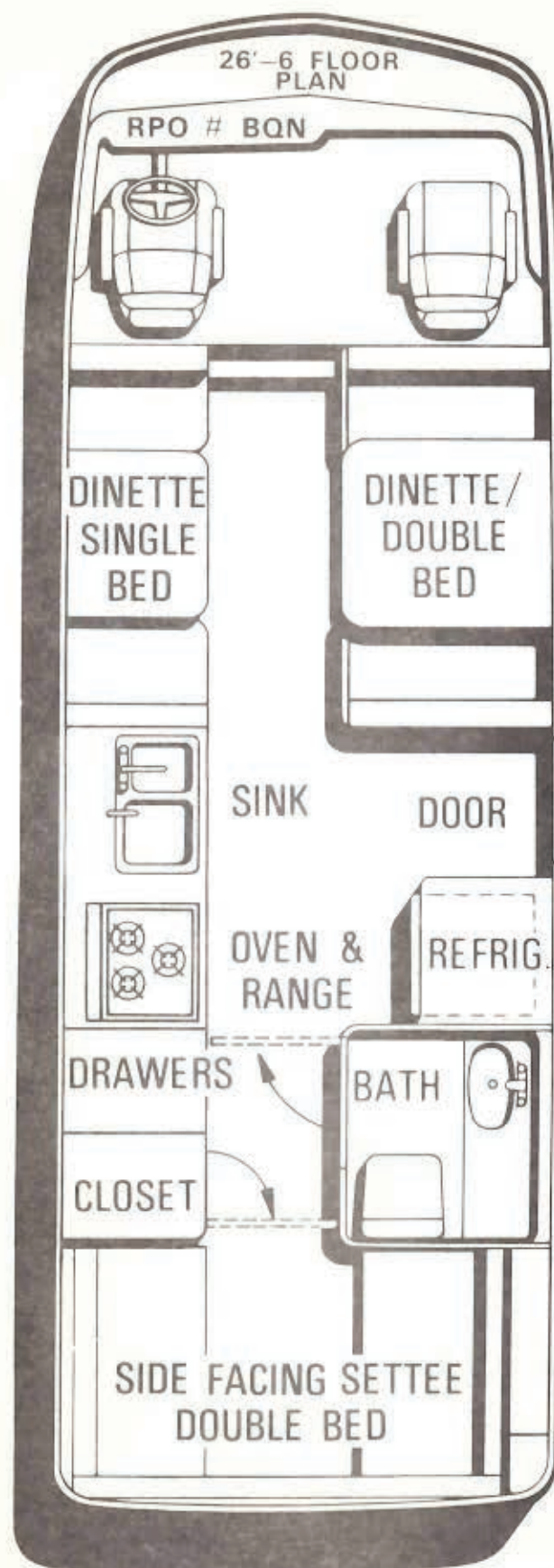
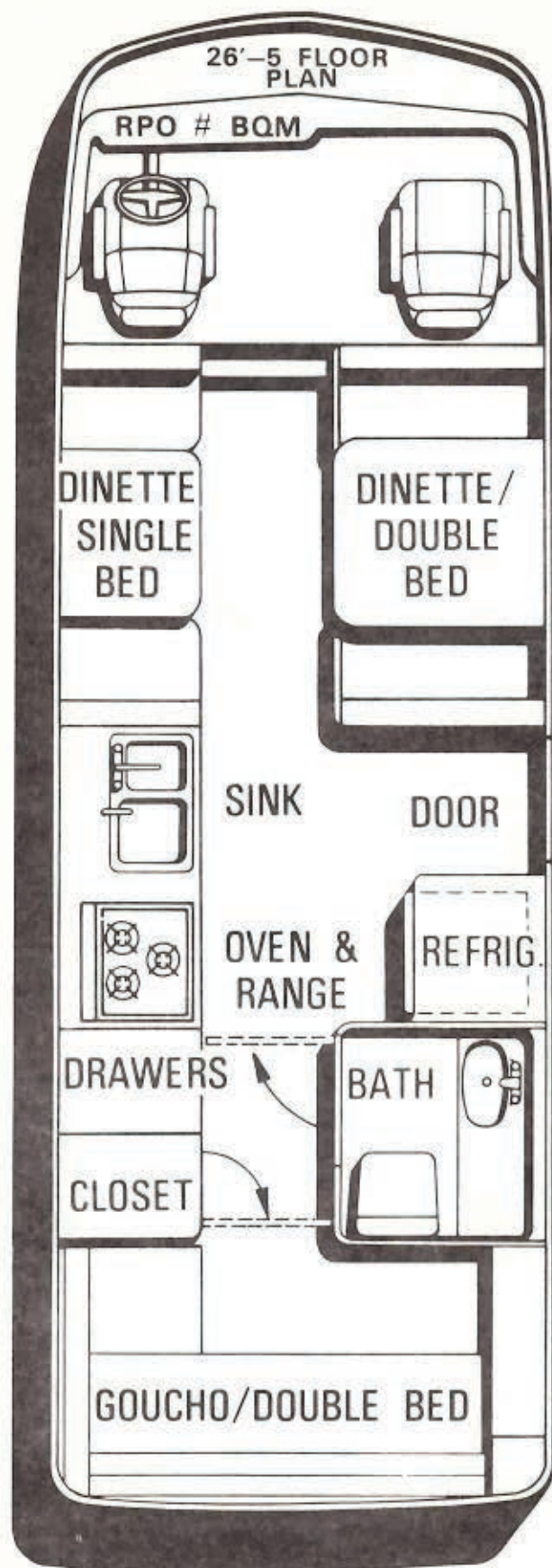

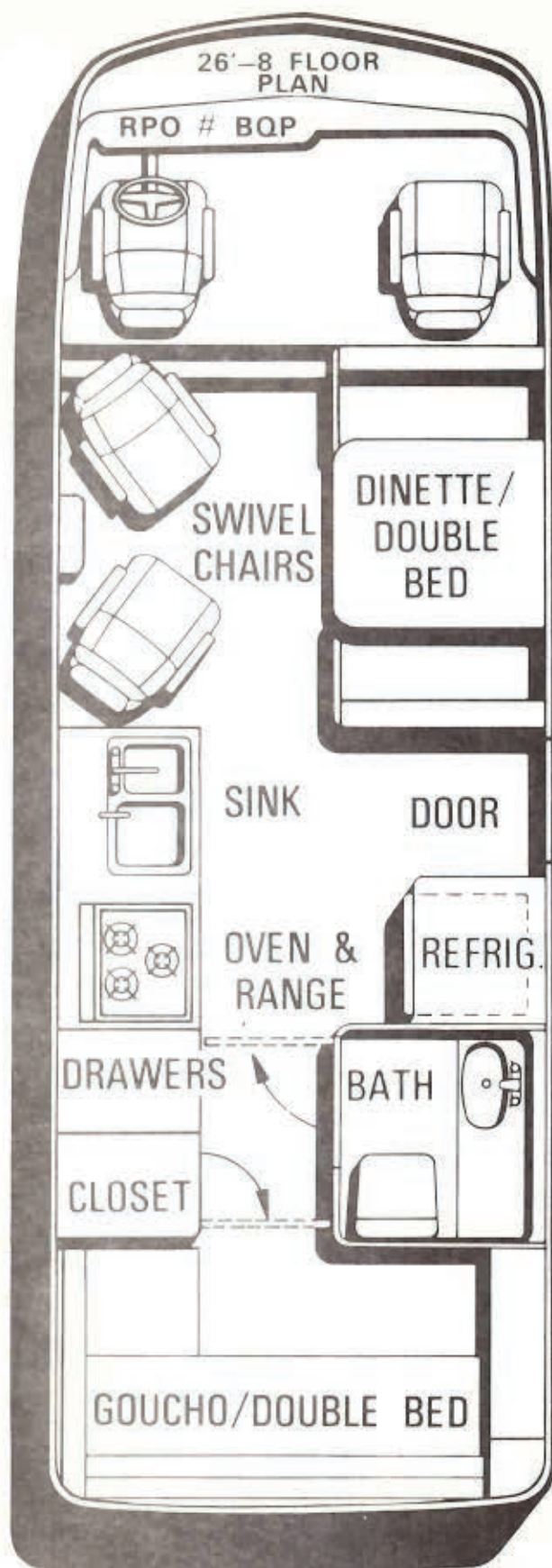
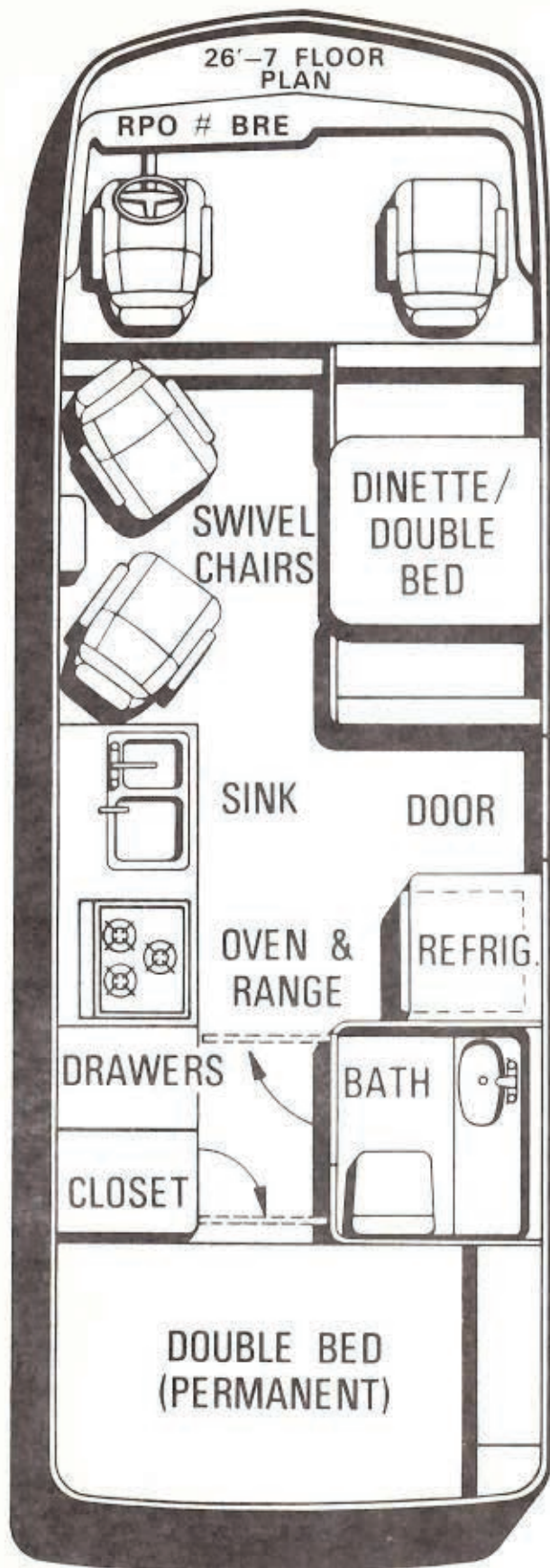

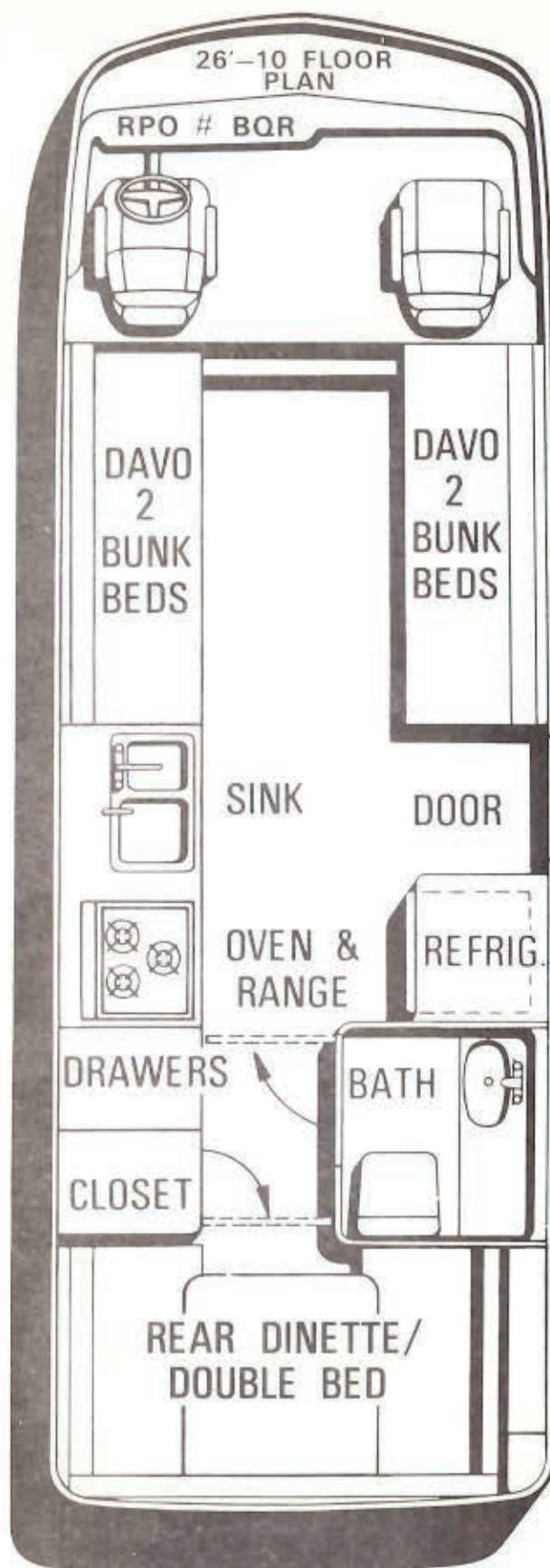
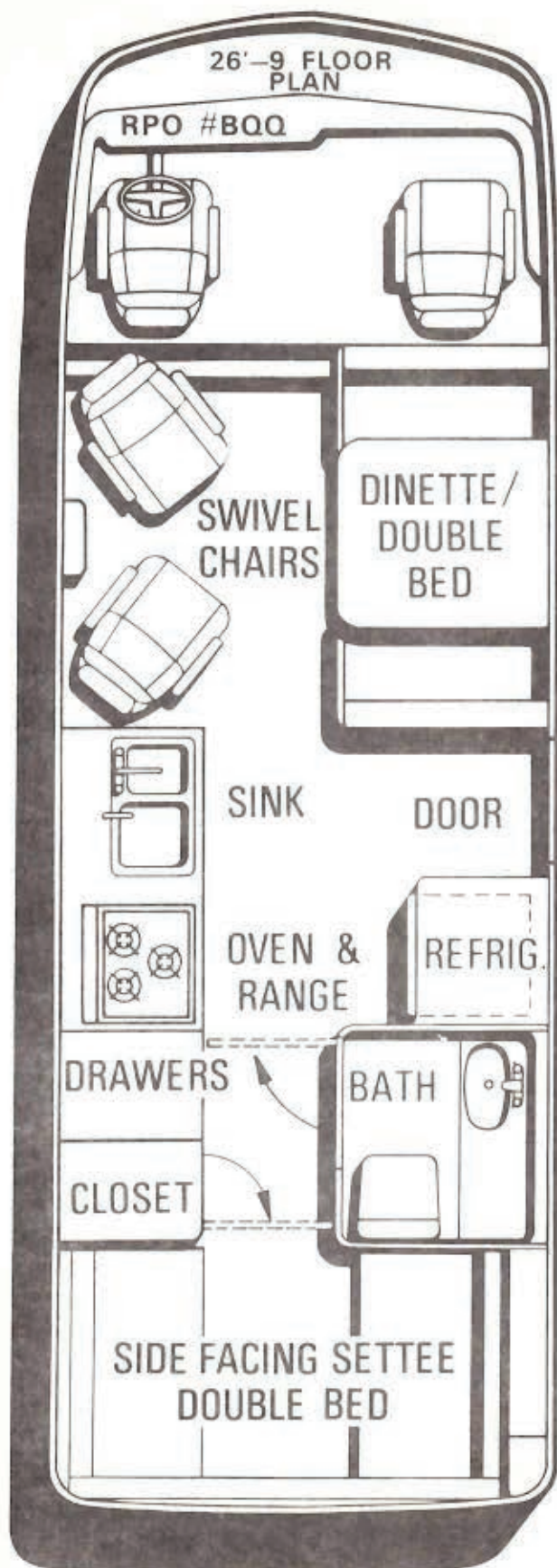

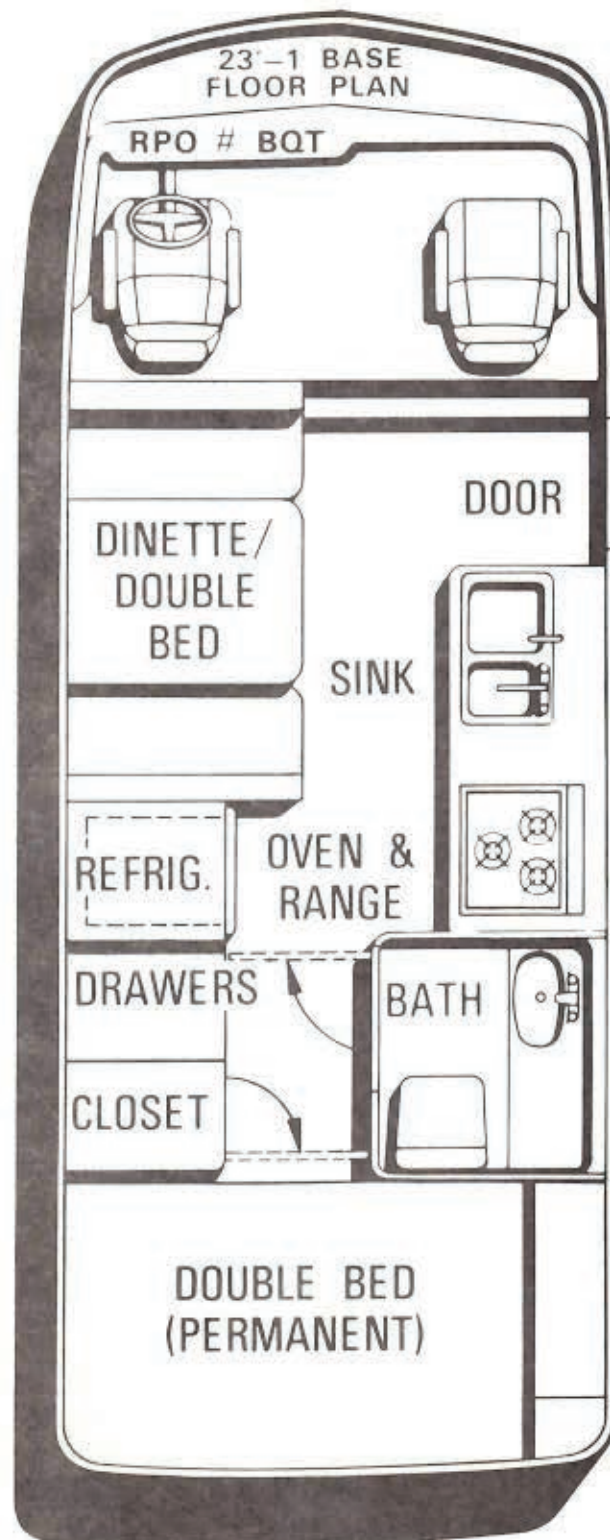
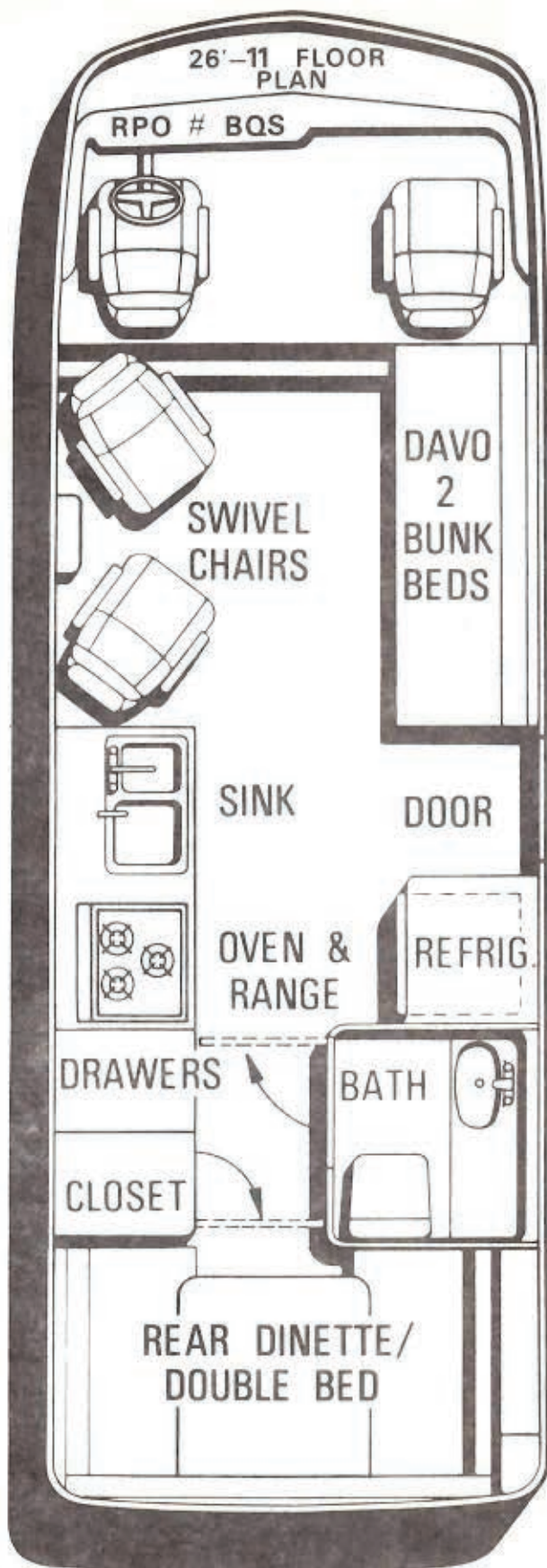

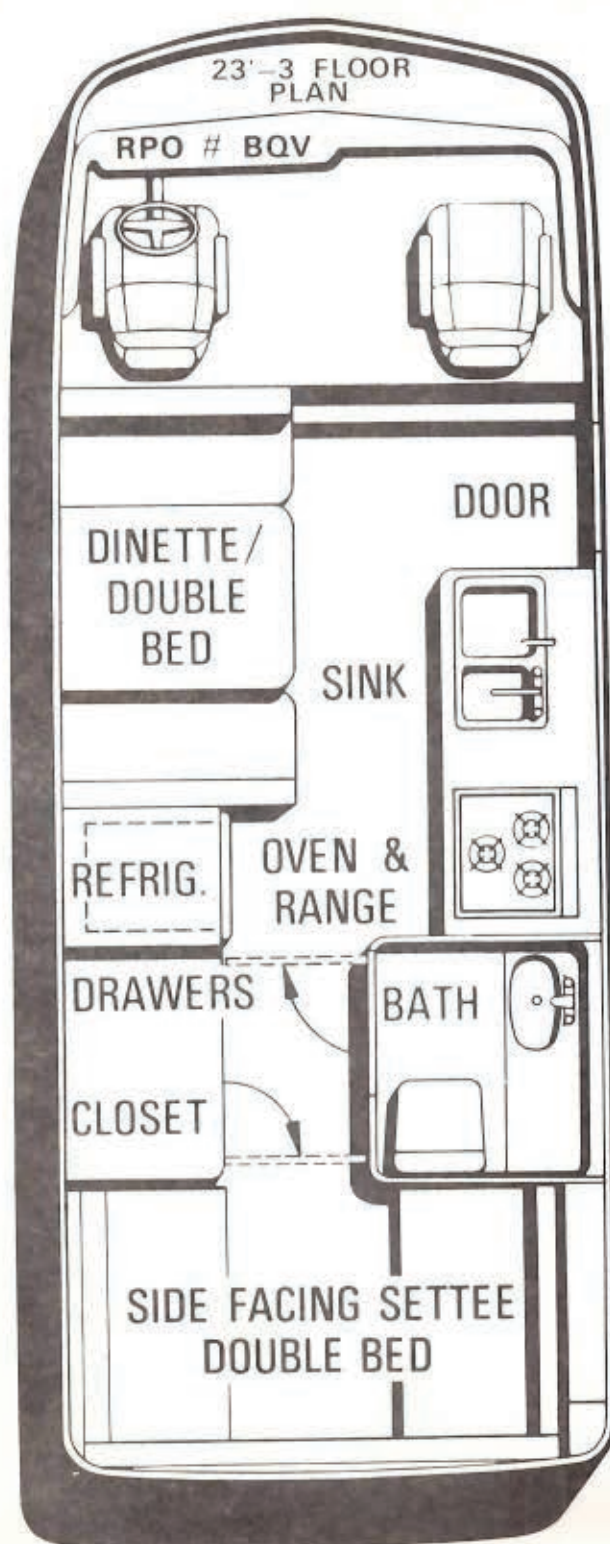
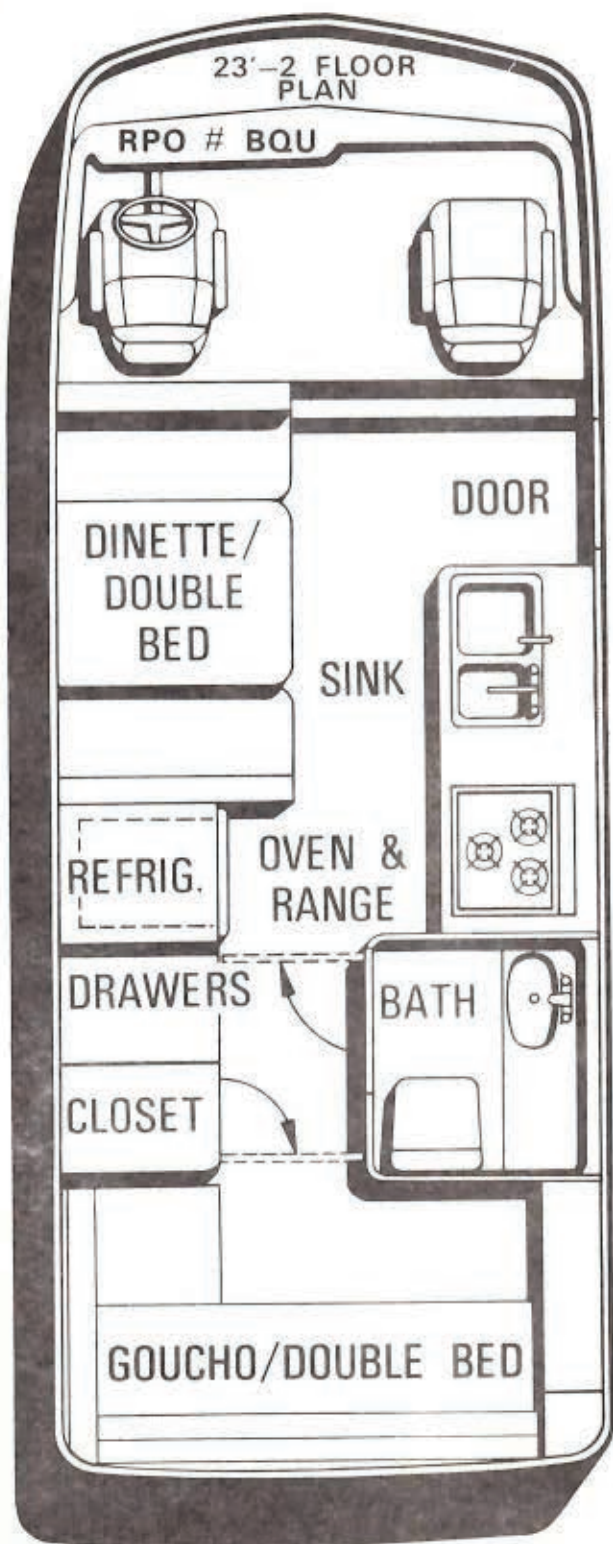

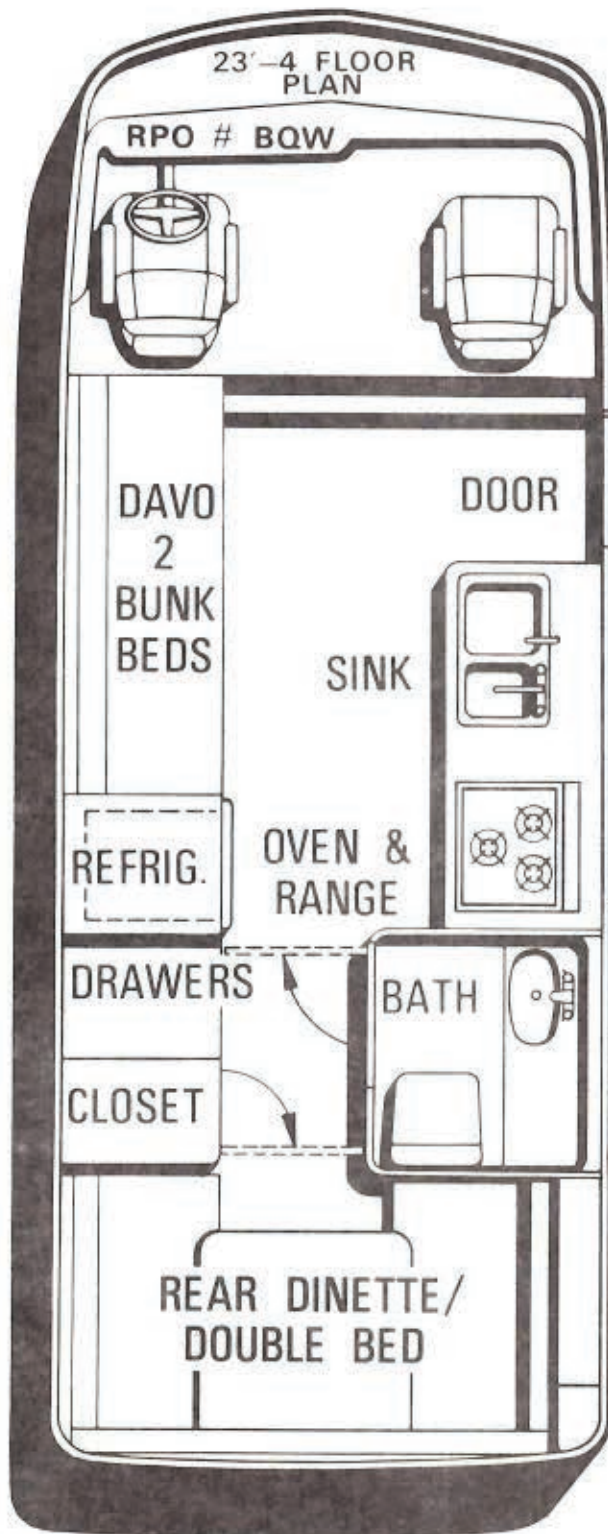

AVAILABLE  
EQUIPMENT

## EXTERIOR PAINT COLORS

532—White  
No Charge

577—Green  
Optional at Addl. Cost

533—Camel  
No Charge

575—Bittersweet  
Optional at Addl. Cost

527—Yellow  
No Charge

554 Sky Blue  
Optional at Addl. Cost

## EXTERIOR AND INTERIOR COLOR AVAILABILITY

EXTERIOR COLOR	OPT. NO.	INTERIOR DECOR GROUP			
		690 Sequoia	692 Painted Desert	693 Glacier	695 Canyon Lands
White	532	X	X	X	X
Camel	533	X	X	X	X
Yellow	527	X	X		X
Green	577	X			
Bittersweet	575		X		X
Sky Blue	554			X	

PRICES

# ZE-05000 MOTOR HOME

## CHASSIS PRICES

MODEL NO. & DESCRIPTION	FACTORY D & H*	LIST PRICE	MFR'S.† SGT'D. RETAIL PRICE
ZE-06081—23 FT.	\$24.06	\$13,545.00	\$13,569.06
ZE-06581—26 FT.	24.06	14,545.00	14,569.06

## OPTIONAL EXTERIOR PAINT COLORS

OPTION NO. & DESCRIPTION	FACTORY D & H*	LIST PRICE	MFR'S. SGT'D. RETAIL PRICE‡
532—White	\$ N.C.	\$ N.C.	\$ N.C.
533—Camel	N.C.	N.C.	N.C.
527—Pineapple Yellow	N.C.	N.C.	N.C.
577—Parrot Green	N.C.	34.00	34.00
575—Bittersweet	N.C.	34.00	34.00
554—Sky Blue	N.C.	34.00	34.00

## CHASSIS AND BODY—AVAILABLE EQUIPMENT

### COMFORT & CONVENIENCE OPTIONS

C70—Air Cond.—Auto. Type	N.C.	482.00	482.00
DAN—Side Accent Stripes	N.C.	86.00	86.00
K30—Cruise Control	N.C.	86.00	86.00
U26—Lamp—Engine Comp.	N.C.	4.25	4.25
UX1—Radio—AM w/4 Speakers	N.C.	97.00	97.00
UX2—Radio—AM/FM Mono w/4 Speakers	N.C.	152.00	152.00
UX3—Radio—AM/FM Stereo w/4 Speakers	N.C.	217.00	217.00
UX4—Radio—AM/Stereo Tape Player w/4 Speakers	N.C.	202.00	202.00
UX5—Radio—AM/FM Stereo w/Tape Player & 4 Speakers	N.C.	312.00	312.00
A58—Dual Pass. Seat	N.C.	60.00	60.00
N33—Tilt Steering Column	N.C.	41.80	41.80
Y71—Thermometer—Outside	N.C.	14.25	14.25
C96—Warning Lights	N.C.	15.00	15.00
A04—Windows—Dark Tinted	N.C.	110.00	110.00

### EXTERIOR TRIM OPTIONS

V37—Bumpers, Chrome	N.C.	75.00	75.00
DJ8—Mirrors—Stainless Steel	N.C.	15.65	15.65
P01—Wheel Covers—Disc (6)	N.C.	45.00	45.00
P02—Wheel Covers—Disc (7)	N.C.	52.50	52.50

### OPERATING—HANDLING & PERFORMANCE OPTIONS

K97—Alternator—80 Amp.	N.C.	58.90	58.90
NA9—Fuel Evap. Emission Sys.	N.C.	17.00	17.00
GYE—Susp. Leveler—Power	N.C.	85.00	85.00
UPA—Trailer Wiring Harness	N.C.	17.50	17.50

\*D & H amount reflect provision for pass through of Tire Weight Tax imposed on manufacturer or importer of tires.

†Manufacturer's Suggested Retail Prices do not include state and local taxes, license fees, options or accessories.

‡State and local taxes not included.

## WHEELS—TIRES

OPTION NO. & DESCRIPTION	FACTORY D & H*	LIST PRICE	MFR'S. SGT'D. RETAIL PRICE‡
105BF—8.75 x 16.5, D B/W—Frt.	\$ N.C.	\$ N.C.	\$ N.C.
105BQT —Rear	N.C.	N.C.	N.C.
105BS —Spare	4.01	72.00	76.01
106BF—8.75 x 16.5, D W/W—Frt.	N.C.	15.60	15.60
106BQT —Rear	N.C.	31.20	31.20
106BS —Spare	4.01	79.80	83.81
105QF—8.75 x 16.5, D Steel Belt B/W —Frt.	N.C.	30.00	30.00
105QQT —Rear	N.C.	60.00	60.00
105QS —Spare	4.01	87.00	91.01
106QF—8.75 x 16.5, D Steel Belt W/W —Frt.	N.C.	45.60	45.60
106QQT —Rear	N.C.	91.20	91.20
106QS —Spare	4.01	94.80	98.81
PNJ—Spare Wheel	N.C.	20.60	20.60
P10—Carrier—Spare Tire	N.C.	21.00	21.00

\*D & H amount reflect provision for pass through of Tire Weight Tax imposed on manufacturer or importer of tires.

‡State and local taxes not included.

## INTERIOR—AVAILABLE EQUIPMENT

OPTION NO. & DESCRIPTION	FACTORY D & H	LIST PRICE	MFRS. SGT'D. RETAIL PRICE†
<b>COMFORT &amp; CONVENIENCE OPTIONS</b>			
UNF—Clock—Battery Op.	Will Advise Price & Availability		
ENP—Drapes—W/S & Side Window	N.C.	\$55.00	\$55.00
ENC—Dinette—Main—Fully Uph.	Will Advise Price & Availability		
UNK—Lights—Aisle & Compt.	N.C.	55.00	55.00
ENE—Locker—Boot	N.C.	14.00	14.00
VNV—Luggage Carrier w/Ladder	N.C.	175.00	175.00
UNH—Monitor Panel	N.C.	120.00	120.00
ANW—Toilet—Recir. Chemical	N.C.	160.00	160.00
UNJ—TV Antenna	Will Advise Price & Availability		
UNL—Vacuum Cleaner—Built In**	N.C.	210.00	210.00
CNM—Ventilator—Roof, RR, Power Exh.			
ZE06081 w/o AC; ZE06581	N.C.	50.00	50.00
ZE06081 w/AC	N.C.	30.00	30.00
CNN—Ventilator—Roof, RR,			
Non-Power	N.C.	30.00	30.00
CNP—Ventilator—Bath, Power Exh.	N.C.	30.00	30.00
CNQ—Ventilator—Roof Frt.,			
Power Exh.	N.C.	30.00	30.00
CNT—Ventilator—Roof Ctr.,			
Non-Power**	N.C.	30.00	30.00
ANY—Waste Disposal—Thermosan	N.C.	650.00	650.00
UNG—Water Heater—Elec.			
w/Eng. Pre-Heat	N.C.	65.00	65.00

### CABINETS & TABLES

ENA—Cabinets—Overhead Frt. R.H.**	N.C.	80.00	80.00
ENM—Cabinets—Overhead Frt. L.H.	N.C.	80.00	80.00
ENJ—Cabinets—R.H. Frt.			
Traditional**	Will Advise Price & Availability		
ENL—Cabinets—L.H. Frt.			
Traditional	Will Advise Price & Availability		
ENV—Cabinets—Rear Traditional	Will Advise Price & Availability		
ENR—Closet—Entrance Door**	N.C.	30.00	30.00
END—Galley—Drs. & Drws.			
Traditional	Will Advise Price & Availability		
ENB—Table—Cocktail, Rear	Will Advise Price & Availability		
ENF—Table—Driver's Compartment	N.C.	17.00	17.00
ENK—Table—Rear Dining	N.C.	50.00	50.00

### GENERATOR, HEATING & AIR CONDITIONING

CNK—Air Cond.—Roof Mtd.	N.C.	525.00	525.00
KNB—Aux. Motor Gen.—			
4000 Watt Onan	N.C.	1285.00	1285.00
KNC—Aux. Motor Gen.—			
6000 Watt Onan**	N.C.	1675.00	1675.00
KND—Aux. Motor Gen.—			
4000 Watt Kohler	N.C.	1185.00	1185.00
KNE—Aux. Motor Gen.—			
6000 Watt Kohler**	Will Advise Price & Availability		

†—Does not include State and Local Taxes  
 \*\*—26 Ft. Model Only

## GENERATOR, HEATING & AIR CONDITIONING (Cont'd)

OPTION NO. & DESCRIPTION	FACTORY D & H	LIST PRICE	MFRS. SGT'D. RETAIL PRICE†
VNW301—Code Insignia—Arizona	N.C.	\$10.00	\$10.00
VNW302—California	N.C.	10.00	10.00
VNW303—Florida	N.C.	10.00	10.00
VNW304—Idaho	N.C.	10.00	10.00
VNW305—Nevada	N.C.	10.00	10.00
VNW306—Oregon	N.C.	10.00	10.00
VNW307—Tennessee	N.C.	10.00	10.00
VNW308—Utah	N.C.	10.00	10.00
VNW309—Washington	N.C.	10.00	10.00
UNM—Converter—AC/DC—			
H.D. 45 Amp.	N.C.	70.00	70.00
UNE—LPG Tank—62 Lbs.**	N.C.	25.00	25.00
CNJ—LPG Furnace—30,000 Btu	N.C.	50.00	50.00
UNN—Pre-Wire for Air Cond.	N.C.	25.00	25.00

### KITCHEN OPTIONS

UNP—Range—4 Burner	N.C.	55.00	55.00
UNA—Refrig.—7.5 Cu. Ft. All Elec.**	N.C.	175.00	175.00
UNB—Refrig.—7 Cu. Ft. Gas/Elec.**	N.C.	205.00	205.00
UNC—Refrig.—6 Cu. Ft. Gas/Elec.	N.C.	80.00	80.00
VNT—Water Purifier	N.C.	90.00	90.00

### DECOR GROUPS

690—Sequoia	N.C.	N.C.	N.C.
692—Painted Desert	N.C.	N.C.	N.C.
693—Glacier	N.C.	N.C.	N.C.
695—Canyon Lands	N.C.	N.C.	N.C.

### FLOOR PLAN GROUPS

26 Ft. Model:			
BQH—26-1 (Base)	N.C.	N.C.	N.C.
BQJ—26-2	N.C.	120.00	120.00
BQK—26-3	N.C.	85.00	85.00
BQL—26-4	N.C.	15.00	15.00
BQM—26-5	N.C.	135.00	135.00
BQN—26-6	N.C.	100.00	100.00
BRE—26-7	N.C.	185.00	185.00
BQP—26-8	N.C.	305.00	305.00
BQQ—26-9	N.C.	270.00	270.00
BQR—26-10	N.C.	135.00	135.00
BQS—26-11	N.C.	320.00	320.00
23 Ft. Model:			
BQT—23-1 (Base)	N.C.	N.C.	N.C.
BQU—23-2	N.C.	120.00	120.00
BQV—23-3	N.C.	85.00	85.00
BQW—23-4	N.C.	135.00	135.00

### OTHER OPTIONS

BQF—Factory Del.—Dealer Driveway	N.C.	32.00	32.00
BQG—Factory Del.—			
Customer Driveway	N.C.	105.00	105.00

†—Does not include State and Local Taxes  
 \*\*—26 Ft. Model Only

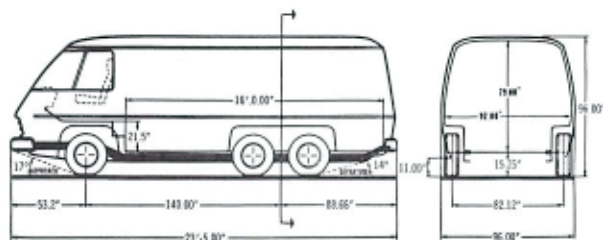

## STANDARD SPECIFICATIONS

### ZE-06081 MODEL (GMC 23-FT. MOTOR HOME)

#### ENGINE.

**Gasoline.** GMC 455, 8 cylinder, V-type with C.C.S.

Net HP @ RPM (SAE).....**265** @ 4300

Net Torque (lbs. ft.) @ RPM (SAE).....**375** @ 2800

Comp. Ratio. 8.5:1.

**Air Cleaner.** Oiled paper element.

**Cooling.** Capacity: 21 qt. tube and center radiator, 9 lb. pressure cap. All season coolant, (-20°F), one 195°F thermostat, 19 in. 7 blade fan.

**Emission Control.** Conforms to Federal Standards.

**Oil Filter.** Throwaway type. 1 Qt.

#### TRANSMISSION.

**Type.** 3 Spd. Turbo Hydramatic HMT425. Ratios: (2.0 converter) 3.45, 2.25, 1.41, 1.00; Rev. 5.02.

#### REAR AXLE.

**Independently Suspended Tandem Wheels** (non-driving), capacity—7000 lbs

**Air Suspension** with leading and trailing arms. Two height control valves, 1 ea. side.

**Shock Absorbers.** Four 1" Dia.

#### FRONT AXLE.

**Torsion Bar Suspension.** Rated capacity 4200 lbs.

**Shock Absorbers.** Two. 1" Dia.

**Steering Integral Gear Power Steering** (17.5:1 ratio).

**Final Drive Ratio.** 3.07:1.

Number of wheel turns, lock to lock; 2.95. Turn. dia. curb to curb; 50.2 ft.

#### BRAKES.

**Type.** Disc front, Drum rear (4) Vacuum boosted, w/dual (split) system and a combination valve which differentiates, meters and holds off front brake pressure until rear brakes contact the Drums.

**Effective Brake Lining Area.**

Front..... 37.88 sq. in.

Rear.....167.0 sq. in.

**Brake Size.**

Front (Disc Type).....11" x 1.205"

Swept Area Per Axle (Sq. In.).....210

Rear (Drum type—4).....11" x 2"

Swept Area Per Axle (Sq. In.).....138

**Total Swept Area.**

(Sq. In.).....486

#### CHASSIS.

**Frame.** Ladder type welded frame with 6 x 2.50 x 0.125 channel SAE 950 side rails and SAE 1023 channel crossmembers.

**Bumpers.** Formed steel, painted silver, 2-piece front and rear. Energy absorbers—2 front and 2 rear.

## STANDARD SPECIFICATIONS Continued

### ZE-06081 MODEL (GMC 23-FT. MOTOR HOME)

#### FUEL AND EXHAUST.

**Fuel Tanks.** Two 25 gal. tanks w/fuel tank gauge selector switch.

**Exhaust.** Dual mufflers and single tail pipe.

#### BODY.

##### Sub-Structure.

Heavy Gauged Alum. Extrusions.

Body Materials.

Fiberglass Frt. & Rear Caps & Lower Side Panels. Alum. Upper Side Panels & Roof.

Insulation. Frt. & Rear Caps. Wood Cellulose Fiber. ¼" on Dash, ½" in Rear Corners.

Main Body. Sprayed in Place Urethane Foam.

1" Treated Plywood Floor.

28" Wide Side Door.

##### Windows.

Windshield—Two Piece Laminated. Glare Resisting & Heat Absorbing, Soft Ray.

Driver Compt.—Side Windows.—Sliding Laminated.

Living Area Windows—One, Screened & Sliding.

Galley & Entrance Door Windows. Fixed.

Bedroom Side Windows—Two Screened & Sliding.

Bedroom Rear Window—One Piece Solid Tempered. Has Kickout Safety Feature.

##### Exterior Colors.

Three (3) Std. Three @ Extra Cost.

Color Keyed Frt. Accent Stripes.

##### Environmental Equipment.

Heating. LPG Furnace—22,000 BTU (Forced Air).

Ventilation. Frt. Roof Mounted & Bathroom Gravity Ventilators.

Fire Extinguisher—2½ lb.

Water Supply. 40 Gal. Polyethylene Tank with 12V Demand Water Pump. With Locking Fillcap.

6 Gal., 110V Hot Water Heater.

City Water Hook-Up System with Locking Door.

Disposal. 32 Gal. Polyethylene Tank.

##### Interior Power

12 V. DC with 30 Amp. AC/DC Battery Converter/Charger.

110 V. AC—25 ft. 40 Amp. Power Cord.

LPG—44.5 lb. Steel Propane Tank.

##### Interior Electrical.

All Lights 12 V.—Located As Follows:

Dinette—(1) on L.H. Side

Sink—(1)

Corridor—(1)

Rear Compartment—(2)

Range Hood—(1)

Bathroom—(2)

Door Courtesy—(1)

Duplex Outlets—110 V. (4)

##### Interior Finishing.

Walls & Roof Insulated w/Foamed in Place Polyurethane.

Ceiling—Vinyl Covered Composite Panel.

Paneling—¾" Vinyl Covered Wood Panel.

Draperies—All Windows Ex. Windshield and Driver Compartment Side Windows.

Driver Compartment Divider Drape.

Carpet—Shag (Color Coordinated).

##### Driver & Passenger Compartment.

Adjustable Contoured Driver & Single Passenger Swivel Seats w/Armrests & Seat Belts.

Two Painted Outside (7½ x 10½) Foldaway Mirrors.

Inside Rear View Mirror.

Left & Right Hand Sun Shades.

Two Ash Trays.

Dome Lamps—Driver & Passenger.

Safety Padded Dash.

Automotive Heater & Defroster.

Glove Compartment.

Map Pocket—Driver & Passenger.

## STANDARD SPECIFICATIONS Continued

### ZE-06081 MODEL (GMC 23-FT. MOTOR HOME)

#### Instruments & Controls.

Windshield Wiper/Washer (Hydraulic Wipers). Variable-speed.

Heater & Defroster, Lighter, Speedometer. Fuel, Temp., Oil, Gauges.

Gen. & Brake Warning Lights.

Key Buzzer Warning System.

Telltale Light—Door Open.

Headlamp Switches.

Hi-Beam Indicators.

Turn Signal Indicators.

#### Living Compartment. (Front).

Main Dinette; Removable Folding Leg Table Used to Convert Area to Double Bed—L.H. Side.

4 Seat Belts.

#### Galley Area.

Refrigerator—6 Cu. Ft. All Electric, 12 V./110 V.

Range—3 Burner with Oven & Hood, 12 V. Fan & Light.

Sink—17" x 24" Stainless Steel Obl. Bowl w/Ledge Back & Swing Spout Faucet.

Cabinets—Under and Over Sink & Refrigerator.

#### Rear Bedroom.

Permanent Double Bed.

Storage Locker.

Rear Upper Cabinets on Each Side.

#### Bathroom.

Two Piece Molded Fiberglass Reinforced Plastic w/Shower & Curtain.

Sink and Faucet.

Medicine Chest w/Mirror.

Thetford 41 Aquamagic Toilet.

#### Hall.

Storage Compt. (Closet, Three Drawers & 2 Doors).

## ELECTRICAL.

**Battery.** 2-12 V. 73 amp. hr. 1-Vehicle, 1-Auxiliary.

**Alternator.** 12 V., 61 amp. Delcotron.

**Headlights**—Single 7" High intensity.

Amber Frt. Directional Signals & Park Lamps.

Combination Stop, Tail, Turn & Backup.

Five Amber (2 Clearance, 3 Identification) Marker Lamps Upper Front.

Five Red Lamps; 2 Clearance, 3 I.D. Markers Upper Rear.

Side Markers (Frt. & Rear With Reflectors—Front Flash With Turn Signals).

4-Way Emergency Flashers.

Porch Light.

## WHEELS—TIRES.

**Tires.** (6) 8.75 x 16.5 (D Load Range) Blackwall. Max. Tire Capacity (Ea.) 2350

**Wheels.** 16.5-6K. 8 stud with 6½" bolt circle. Offset: 4.67".

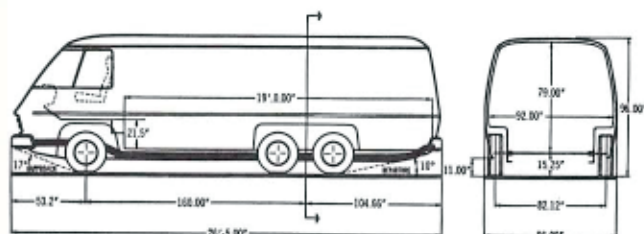

## STANDARD SPECIFICATIONS

### ZE-06581 MODEL (GMC 26-FT. MOTOR HOME)

#### ENGINE.

**Gasoline.** GMC 455, 8 cylinder, V-type with C.C.S.

Net HP @ RPM (SAE).....	265 @ 4300
Net Torque (lbs. ft.) @ RPM (SAE).....	375 @ 2800
Comp. Ratio. 8.5:1.	

**Air Cleaner.** Oiled paper element.

**Cooling.** Capacity: 21 qt. tube and center radiator, 9 lb. pressure cap. All season coolant, (-20°F), one 195°F thermostat, 19 in. 7 blade fan.

**Emission Control.** Conforms to Federal Standards.

**Oil Filter.** Throwaway type. 1 Qt.

#### TRANSMISSION.

**Type.** 3 Spd. Turbo Hydramatic HMT425. Ratios: (2.0 converter) 3.45, 2.25, 1.41, 1.00; Rev. 5.02.

#### REAR AXLE.

**Independently Suspended Tandem Wheels** (non-driving), capacity—7000 lbs.

**Air Suspension** with leading and trailing arms. Two height control valves. 1 ea. side.

**Shock Absorbers.** Four 1" Dia.

#### FRONT AXLE.

**Torsion Bar Suspension.** Rated capacity 4200 lbs.

**Shock Absorbers.** Two. 1" Dia.

**Steering Integral Gear Power Steering** (17.5:1 ratio).

**Final Drive Ratio.** 3.07:1.

Number of wheel turns, lock to lock; 2.95. Turn. dia. curb to curb: 56.41 ft.

#### BRAKES.

**Type.** Disc front, Drum rear (4) Vacuum boosted, w/dual (split) system and a combination valve which differentiates, meters and holds off front brake pressure until rear brakes contact the Drums.

**Effective Brake Lining Area.**

Front.....	37.88 sq. in.
Rear.....	167.0 sq. in.

**Brake Size.**

Front (Disc Type).....	11" x 1.205"
Swept Area Per Axle (Sq. In.).....	210
Rear (Drum type—4).....	11" x 2"
Swept Area Per Axle (Sq. In.).....	138

**Total Swept Area.**

(Sq. In.).....	486
----------------	-----

#### CHASSIS.

**Frame.** Ladder type welded frame with 6 x 2.50 x 0.125 channel SAE 950 side rails and SAE 1023 channel crossmembers.

**Bumpers.** Formed steel, painted silver, 2-piece front and rear. Energy absorbers—2 front and 2 rear.

#### FUEL AND EXHAUST.

**Fuel Tanks.** Two 25 gal. tanks w/fuel tank gauge selector switch.

**Exhaust.** Dual mufflers and single tail pipe.

## STANDARD SPECIFICATIONS Continued

### ZE-06581 MODEL (GMC 26-FT. MOTOR HOME)

#### BODY.

##### Sub-Structure.

Heavy Gauged Alum. Extrusions.

Body Materials.

Fiberglass Frt. & Rear Caps & Lower Side Panels. Alum. Upper Side Panels & Roof.

Insulation. Frt. & Rear Caps. Wood Cellulose Fiber, ¼" on Dash, ½" in Rear Corners.

Main Body. Sprayed in Place Urethane Foam.

1" Treated Plywood Floor.

28" Wide Side Door.

##### Windows.

Windshield—Two Piece Laminated. Glare Resisting & Heat Absorbing, Soft Ray.

Driver Comp. —Side Windows—Sliding Laminated.

Living Area Windows—Two, Screened & Sliding.

Galley & Entrance Door Windows. Fixed.

Bedroom Side Windows—Two Screened & Sliding.

Bedroom Rear Window—One Piece Solid Tempered. Has Kickout Safety Feature.

##### Exterior Colors.

Three (3) Std. Three (3) @ Extra Cost.

Color Keyed Frt. Accent Stripes.

##### Environmental Equipment.

Heating. LPG Furnace—22,000 BTU (Forced Air).

Ventilation. Frt. Roof Mounted & Bathroom Gravity Ventilators.

Fire Extinguisher—2½ lb.

Water Supply. 40 Gal. Polyethylene Tank with 12V Demand Water Pump with Locking Fillcap.

6 Gal., 110V. Hot Water Heater.

City Water Hook-Up System with Locking Door.

Disposal. 32 Gal. Polyethylene Tank.

##### Interior Power.

12 V. DC with 30 Amp. AC/DC Battery Converter/Charger.

110 V. AC—25 ft. 40 Amp. Power Cord.

LPG—44.5 lb. Steel Propane Tank.

##### Interior Electrical.

All Lights 12 V.—Located As Follows:

Dinette—(2) One L.H. Side—One R.H. Side	Sink—(1)
Corridor—(1)	Rear Compartment—(2)
Range Hood—(1)	Bathroom—(2)
Door Courtesy—(1)	Duplex Outlets—110 V. (4)

##### Interior Finishing.

Walls & Roof Insulated w/Foamed in Place Polyurethane.

Ceiling—Vinyl Covered Composite Panel.

Paneling—¾" Vinyl Covered Wood Panel.

Drapery—All Windows Ex. Windshield and Driver Compartment Side Windows.

Driver Compartment Divider Drape.

Carpet—Shag (Color Coordinated).

##### Driver & Passenger Compartment.

Adjustable Contoured Driver & Single Passenger Swivel Seats w/Armrests & Seat Belts.

Two Painted Outside (7½ x 10½) Foldaway Mirrors.

Inside Rear View Mirror.

Left & Right Hand Sun Shades.

Two Ash Trays.

Dome Lamps—Driver & Passenger.

Safety Padded Dash.

Automotive Heater & Defroster.

Glove Compartment.

Map Pocket—Driver & Passenger.

## STANDARD SPECIFICATIONS Continued

### ZE-06581 MODEL (GMC 26-FT. MOTOR HOME)

#### Instruments & Controls.

Windshield Wiper/Washer (Hydraulic Wipers). Variable-speed.  
Heater & Defroster, Lighter, Speedometer, Fuel, Temp., Oil, Gauges.  
Gen. & Brake Warning Lights.  
Key Buzzer Warning System.  
Telltale Light—Door Open.  
Headlamp Switches.  
Hi-Beam Indicator.  
Turn Signal Indicators.

#### Living Compartment. (Front).

Main Dinette. Removable Folding Leg Table Used to Convert Area to Double Bed—R.H. Side.  
4 Seat Belts.  
Davo—Converts to Upper & Low Bunk Beds (30" x 76") L.H. Side

#### Galley Area.

Refrigerator—6 Cu. Ft. All Electric, 12 V./110 V.  
Range—3 Burner with Oven & Hood, 12 V. Fan & Light.  
Sink—17" x 24" Stainless Steel Dbl. Bowl w/Ledge Back & Swing Spout Faucet.  
Cabinets—Under and Over Sink & Refrigerator.

#### Rear Bedroom.

Permanent Double Bed.  
Storage Locker.  
Rear Upper Cabinets on Each Side.

#### Bathroom.

Two Piece Molded Fiberglass Reinforced Plastic w/Shower & Curtain.  
Sink and Faucet.  
Medicine Chest w/Mirror.  
Thetford 41 Aquamagic Toilet.

#### Hall.

Storage Compt. (Closet, Three Drawers & 2 Doors).

---

#### ELECTRICAL.

**Battery.** 2-12 V. 73 amp. hr. 1-Vehicle, 1-Auxiliary.

**Alternator.** 12 V., 61 amp. Delcotron.

**Headlights**—Single 7" High Intensity.

Amber Frt. Directional Signals & Park. Lamps.  
Combination Stop, Tail, Turn & Backup  
Five Amber (2 Clearance, 3 Identification) Marker Lamps Upper Front  
Five Red Lamps; 2 Clearance, 3 I.D. Markers Upper Rear.  
Side Markers (Frt. & Rear With Reflectors—Front Flash With Turn Signals)  
4-Way Emergency Flashers  
Porch Light

---

#### WHEELS—TIRES.

**Tires.** (6) 8.75 x 16.5 (D Load Range) Blackwall. Max. Tire Capacity (Ea.) 2350

**Wheels.** 16.5-6K. 8 stud with 6½" bolt circle. Offset: 4.67".